

⚠ It is essential to read the operating instructions and pay particular attention to the warnings and safety instructions.

Control field and sensor controls

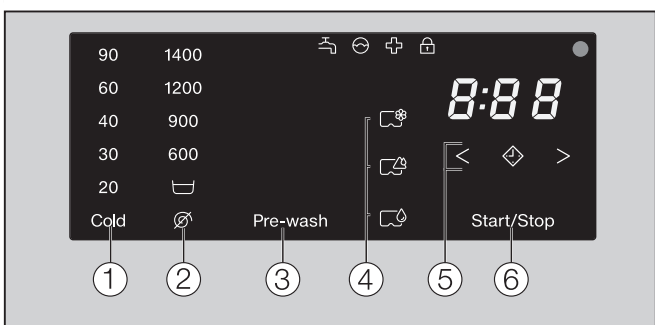

The sensor controls 1–6 react to fingertip contact. If a sensor control is illuminated, it can be selected.

Sensor control = Delay start: select the required time with the < or > control.

Programme selection

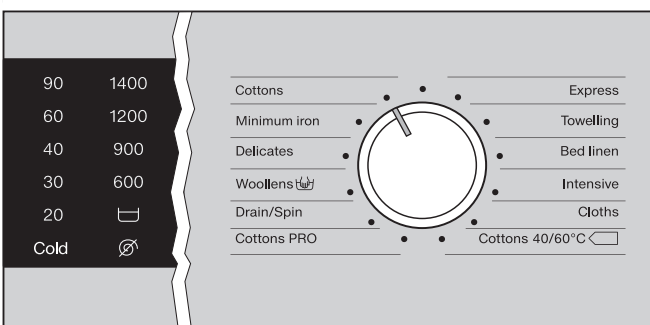

- Turn the programme selector to select a programme. The available temperatures and spin speeds light up.
- If a sensor control is brightly lit, this means it is currently selected.
- If a sensor control is dimly lit, this means it can be selected.

Indicator lights

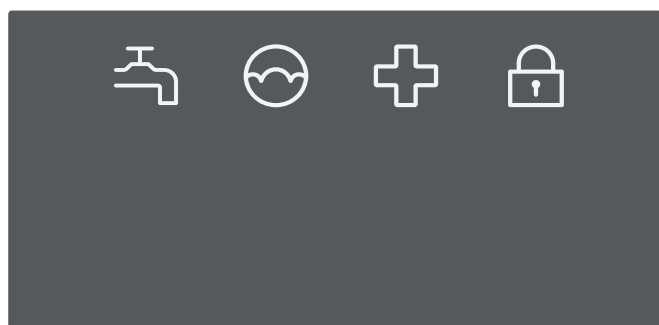

- Water intake or drainage fault.
- Excess detergent used.
- Reminder about hygiene information.
- Lit: the door is locked.
- Flashing: laundry can be added.

1 Loading the laundry

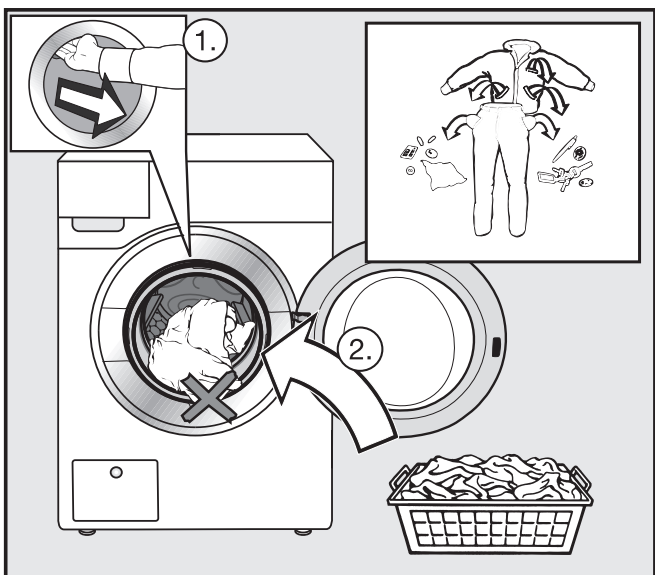

- Open the door.
- Load the laundry, sorted by colour and care label.
- Shut the door with a gentle swing. Make sure items do not get caught in the door.

3 Adding detergent

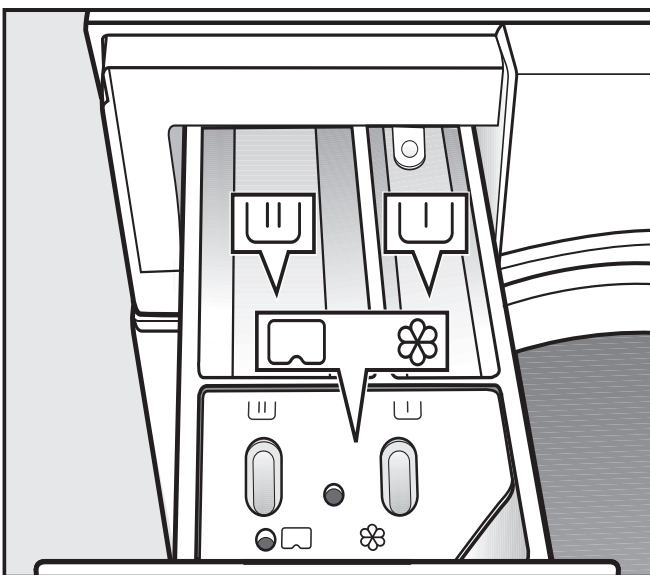

- Detergent for the pre-wash.
- Detergent for the main wash.
- Fabric softener, liquid starch or capsules.

4 Selecting and starting the programme

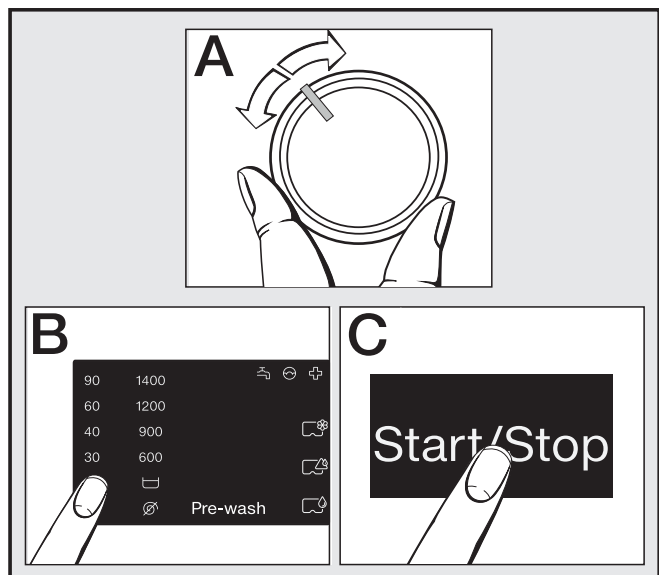

- Select a programme (A).
- Select the temperature, spin speed and pre-wash (B).
- Touch the *Start/Stop* sensor control (C).

5 Unloading the laundry

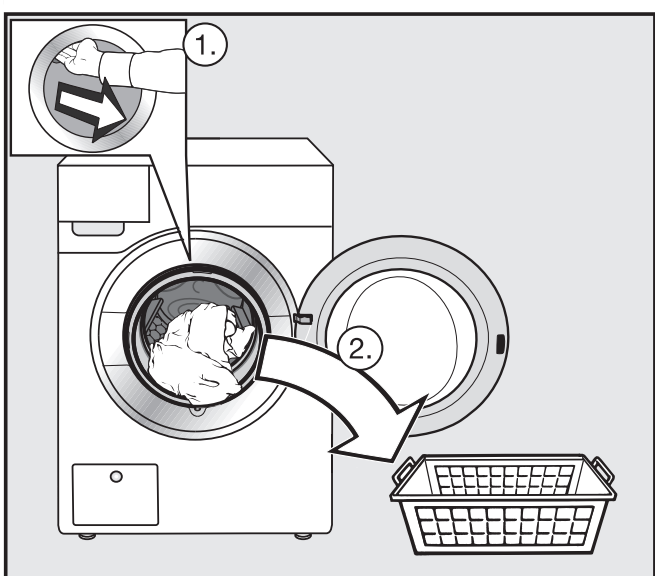

- The time display shows 0:00. The symbol lights up in the control field.
- Release the door with the *Start/Stop* sensor control.
 - Open the door and remove the laundry.

Opening the door in the event of a power failure

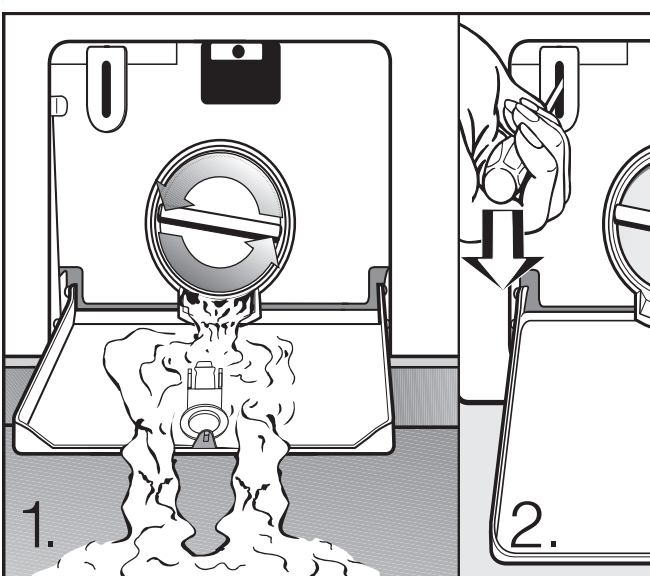

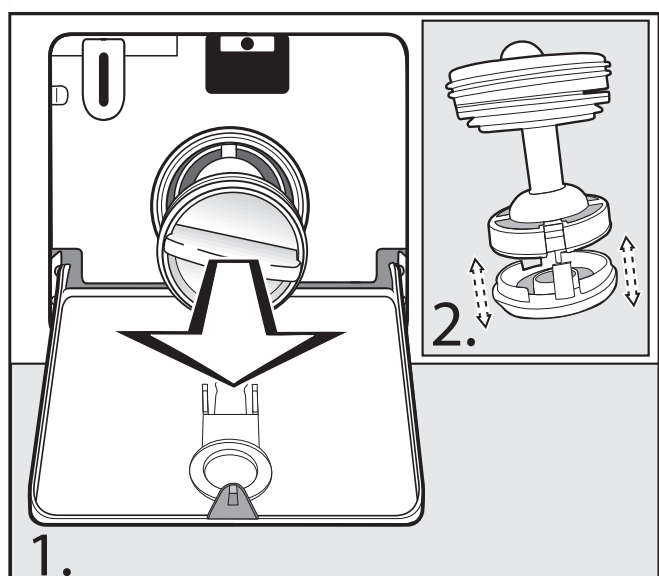

- Open the access panel to the drain system.
- Allow the water to drain off. Be careful: the water may be hot.
- Release the door with a screwdriver.

Cleaning the drain filter



- Allow the water to drain off.
- Unscrew the drain filter completely.
- Clean the drain filter thoroughly.
- Replace the drain filter and tighten it securely.

Programme		Load
Cottons cold to 90 °C		max. 7.0 kg
Items	Cotton, linen and mixed fibre textiles.	
Tip	<ul style="list-style-type: none"> – Select the temperature according to the instructions on the care label, the detergent, the type of soiling and the hygiene requirements. – For dark-coloured fabric, use a colour detergent or liquid detergent. 	
Minimum iron cold to 60 °C		max. 4.0 kg
Items	Synthetic and mixed fibre textiles as well as easy care cotton.	
Tip	– Reduce the final spin speed for fabric that creases easily.	
Delicates cold to 40 °C		max. 2.5 kg
Items	Delicate garments made from synthetic fibre, mixed fibre and viscose.	
Tip	– Deselect the final spin speed for fabric that creases easily.	
Woollens cold to 30 °C		max. 2.0 kg
Items	Machine-washable woollens and woollen blends.	
Tip	– Use detergent formulated for woollens.	
Cottons PRO 60 °C		max. 7.0 kg
Items	Mixed fibre textiles (50 % cotton and 50 % polyester).	
Tip	– Extra energy-efficient wash programme for commercial cotton or cotton/synthetic blend textiles with normal levels of soiling, e.g. workwear.	
Express 30 °C		max. 3.5 kg
Items	Cotton garments that have hardly been worn or are only very lightly soiled.	
Towelling 40 °C to 60 °C		max. 6.0 kg
Items	Towels and bathrobes made from terrycloth.	
Tip	– For dark-coloured fabric, use a colour detergent or liquid detergent.	
Bed linen 40 °C to 90 °C		max. 6.0 kg
Items	Cotton or mixed fibre bed linen.	
Tip	<ul style="list-style-type: none"> – The items are always soaked after the start. – Use a colour detergent for coloured textiles. 	
Intensive 40 °C to 90 °C		max. 7.0 kg
Items	Heavily soiled workwear made from cotton, linen and mixed fibres.	
Tip	– You can achieve particularly good wash and rinse results with a high water level.	
Cloths 40 °C to 90 °C		max. 4.0 kg
Items	Cotton, mixed fibre or microfibre mops and cloths.	
Tip	<ul style="list-style-type: none"> – The programme is designed to wash mops and cleaning cloths. – A pre-spin and a pre-rinse cycle are carried out before the main wash. 	
Cottons Eco  40 °C/60 °C		max. 7.0 kg
Items	Normally soiled cotton items.	
Tip	<ul style="list-style-type: none"> – These settings are the most efficient in terms of energy and water consumption for washing cottons. With , the wash temperature reached is below 60 °C. 	

