

How to design an effective laundry in a **Care Home**



Miele Professional Fact Sheet



How to design an effective laundry in a **Care Home**

There are many considerations to take on board when designing a laundry in a Care Home. Care Homes typically have laundries on site to cope with the type of work involved. Commercial washing machines and dryers should always be used in a Care Home setting to meet health regulations and because of the robustness of the machine build. Reliability of the machines is a key concern for Care Home owners as any machine down times will have a large impact on the residents care.

Factors to consider are:

■ Number of residents

This will determine the size of machines required.
The industry calculation for determining the laundry size in a residential home is:



In order to work out the exact size of machines required however please speak to one of our Miele Professional Partners.

■ Type of Care Home

If it is a Nursing Home then following the calculation above the machine size will need to be bigger and there will also be a need for the machines to have a sluice option.

■ Laundry location

Ideally laundries should be on the ground floor to make installation and servicing easier. In addition the accessibility of the site overall needs to be taken into account for delivery of the large machines.

■ Laundry size

The room needs to be large enough to fit the machines and for the laundry to be moved around the machines. Trolleys, racking and ironers are important factors in a Care Home laundry room so need to be taken into account.

Room considerations:

■ Flooring

Floors should be suitable for washing down with water and disinfectant and care should be taken to ensure that chemicals will not damage the surface.

■ Ventilation

Considerations should be taken as to how the machines are going to be ventilated. Appropriate ventilation of the room for the laundry workers also needs to be taken into account.

■ Services

Services required in a laundry room include:



Electricity



Water



Gas

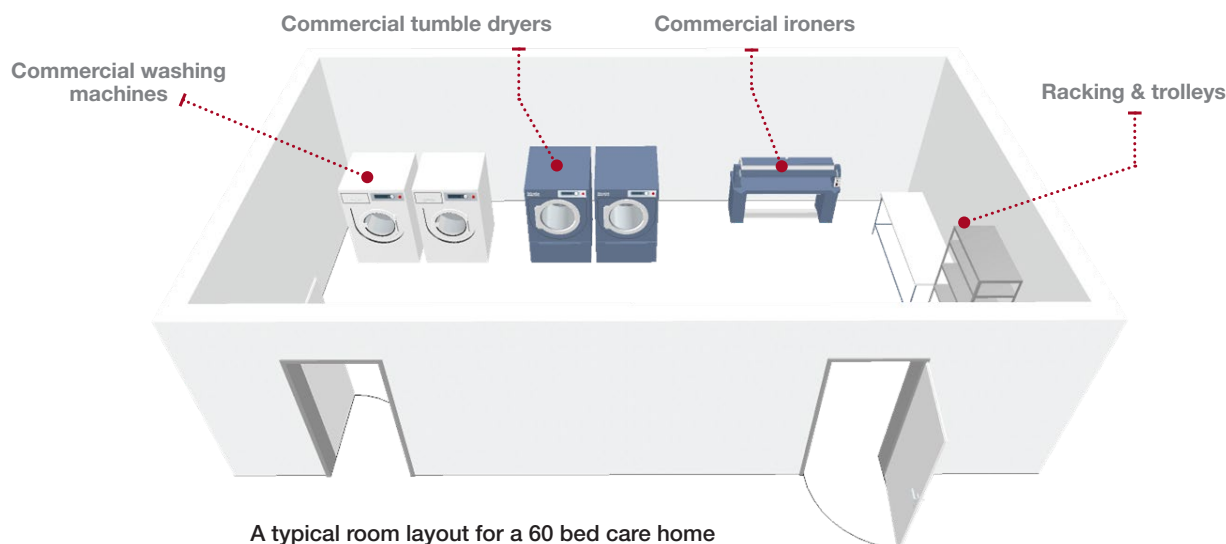

Laundry flow and handling

It is also important to have an understanding of how the flow of laundry works in a Care Home. Due to regulations and standards dirty linen and soiled linen has to be stored and processed in the laundry separately to clean linen. It is recommended that soiled linen (linen which is soiled, blood contaminated or used by someone with an infection) either gets stored in sealed, colour coded bags which are only opened when being loaded into the machine, or in red alginate bags which can be placed directly into the machine. (Image 1)

In Europe best practice involves separating the clean and unclean laundry via separate, air-sealed rooms and using barrier washing machines which can be placed directly into a wall. It is anticipated that regulations may change in the UK in the future to follow this. (Image 2)

Infection control guidelines

The Department of Health has published guidelines referring to laundry management in health care, which are named the **Choice Framework for Policy and Procedures 01-04: Decontamination of linen for health and social care: Engineering, equipment and validation (CfPP 01-04)**. These guidelines state that in order to kill bacteria linen should be thermally disinfected using washing cycles that achieve 65 degrees celsius for at least ten minutes, or 71 degrees for at least three minutes. The guidelines state that a washing machine's disinfection stage should be validated at least once per year to prove that it meets the required temperatures. The NeQis unit is an independent validation tool that monitors the two key metrics - temperature and time - in every wash, along with the proof-of-delivery of detergent into the drum.



Thermal disinfection.

To kill bacteria, the temperature to wash contaminated laundry should be continuously maintained at or above **65°C for at least ten minutes, 71°C for at least three minutes or 82°C for at least one minute**



Independent validation system.

To ensure that washing machines are performing to these standards;

- The disinfection processes should be validated before use
- The performance of the process should be monitored during routine use



It is essential that the laundry equipment in a Care Home environment conforms to the Water Regulations Advisory Scheme (WRAS) Category 5 waste water regulations so that contaminated water cannot enter the water supply. Miele Professional washing machines all meet these requirements.

Colour coded and sealed laundry bags to separate soiled laundry

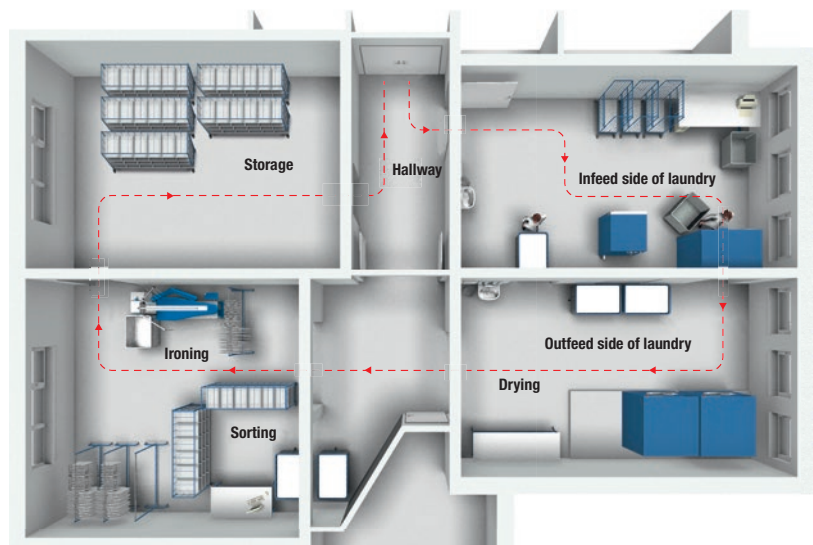

A typical room layout for a barrier wash system for a 60 bed care home

Miele



Contact Miele Professional for more information

☎ 0330 8387428 ✉ professional.info@miele.co.uk

🌐 www.miele.co.uk/professional 🐦 @MieleProf in [mieleprofessional](https://www.linkedin.com/company/mieleprofessional)