

Operating instructions for dishwashers



To avoid the risk of accidents or damage to the appliance, it is **essential** to read these instructions as well as the installation sheet before it is installed and used for the first time.

Guide to the appliance	6
Overview	6
Control panel	7
Display	8
Warning and Safety instructions	9
Caring for the environment	18
Energy saving washing	19
EcoFeedback consumption indicator	20
Before using for the first time	21
Opening the door	21
Emergency door opener	22
Closing the door	22
Basic settings	23
Before using the appliance for the first time, you require:	25
Dishwasher salt	25
Adding salt	26
Add salt reminder	27
Rinse aid	28
Adding rinse aid	28
Add rinse aid reminder	29
Loading the dishwasher	30
Notes	30
FlexAssist	32
Upper basket	32
Adjusting the upper basket	35
Lower basket	36
Cutlery	39
3D Cutlery tray + (depending on model)	39
Loading examples	41
Dishwashers with cutlery tray	41
Operation	43
Detergent	43
Adding detergent	45
Switching on	46
Selecting a programme	46
Starting the programme	47
Time display	47
TimeControl	48
Energy management	48

Contents

At the end of the programme	49
Switching off.....	50
Unloading the dishwasher.....	50
Interrupting a programme.....	51
Changing a programme.....	51
Programme options	52
Extras	52
Delay start	54
Heat exchanger	58
DetergentAgent	59
Programme chart	60
Further programmes.....	64
Cleaning and care	65
Cleaning the wash cabinet	65
Cleaning the door and the door seal	65
Cleaning the control panel	65
Cleaning the reflector panel	65
Cleaning the door front	66
Checking the filters in the wash cabinet	67
Cleaning the filters.....	67
Cleaning the spray arms.....	69
Problem solving guide	70
Technical problems	70
Water inlet fault	73
Water drainage fault	74
General problems	75
Noises.....	77
Unsatisfactory washing result	78
Maintenance	81
Cleaning the water inlet filter.....	81
Cleaning the drain pump and non-return valve.....	82
After sales service	83
Repairs	83
Guarantee	83
Note for test institutes	83
Optional accessories	84
Miele@home	86

Electrical connection	88
Plumbing	89
The Miele waterproof anti-leak system	89
Connection to the water supply	89
Drainage	91
Technical data	92
Technical data	92
Settings menu	93
To open the Settings menu	93
Language 	94
Time.....	94
Water hardness	95
Rinse aid.....	96
Consumption (EcoFeedback)	96
EcoStart.....	97
Networking	99
Miele@home	99
Change main menu	103
Save extras	103
Temperature	103
Brightness	103
Volume.....	104
Memory	105
Check filters	105
Automatic	105
AutoOpen	106
Knock2open	106
Optimise standby	107
BrilliantLight.....	107
Heat exchanger	107
Software version.....	108
Showroom programme.....	108
Factory default.....	108
To close the Settings menu	108

Guide to the appliance



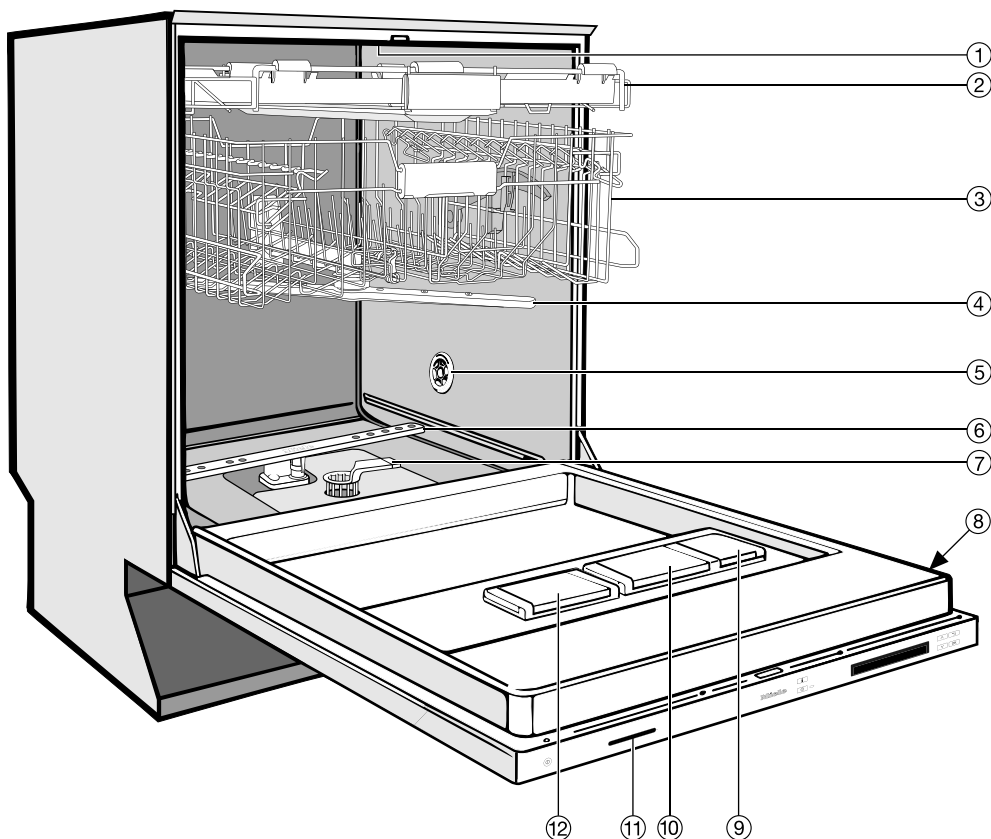

Overview

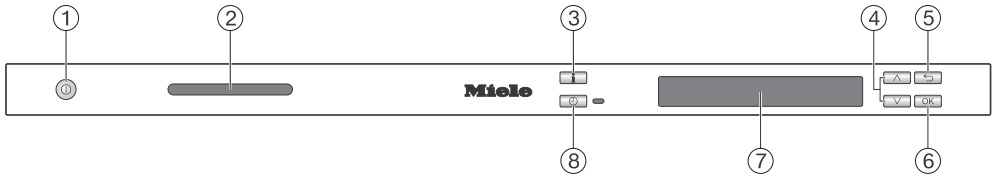

- | | |
|---------------------------------------|---|
| ① Upper spray arm (not visible) | ⑦ Filter combination |
| ② Cutlery tray (depending on model) | ⑧ Data plate |
| ③ Upper basket | ⑨ Rinse aid reservoir |
| ④ Middle spray arm | ⑩ Dual compartment detergent dispenser |
| ⑤ Heat exchanger (depending on model) | ⑪ TimeControl in-operation indicator lights |
| ⑥ Lower spray arm | ⑫ Salt reservoir |

Control panel



- ① **On/Off button** 
For switching the dishwasher on and off.
- ② **TimeControl in-operation indicator lights**
For displaying programme time remaining with the door shut.
- ③ **Information button** 
For displaying additional information about the option in the display.
- ④ **Arrow buttons** 
For selecting programmes.
For altering values shown in the display.
For navigating between different menus.
- ⑤ **Back button** 
For navigating back to the previous menu or deleting values which have been set previously.
- ⑥ **OK sensor**
For selecting the option shown in the display.
For confirming messages.
- ⑦ **Display**
See next page for more information.
- ⑧ **Delay start sensor**  **with indicator light**
For selecting the "Delay start" function.

This instruction book applies to several different dishwasher models.
The specific dishwasher models are referred to as follows:
Standard = 80.5 cm high dishwashers (integrated)
and 84.5 cm high dishwashers (freestanding)
XXL = 84.5 cm high dishwashers (integrated).

Guide to the appliance

Display

General

The display is used to select or set the following:



- the programme
- any extras
- the delay start function
- the Settings  menu
- information

The display can show the following:

- the programme name
- the stage the programme is at
- the current time of day
- the estimated time left for the programme to run
- the energy and water consumption (EcoFeedback)
- any relevant fault messages and information

To save energy, the dishwasher switches off after a few minutes if you do not press any sensors during this time.

To switch the dishwasher back on again, press the  sensor.

The scroll bar  on the right of the display indicates that more options or more text are available which can be displayed by touching the relevant arrow sensor  .

A dotted line will appear under the last option available in a list.

The OK sensor is used to confirm a message or setting and also to move to the next menu or another level.

A tick  will appear beside the option which is currently selected.

To exit a sub-menu, touch the Back sensor .

If you do not press any of the sensors for several seconds, the display will return to the previous level. You may need to enter your settings again.

The touch on metal sensor buttons react to pressure and not simply to touch.

The Settings  menu is used to alter the dishwasher's electronics to suit different requirements (see "Settings").

Warning and Safety instructions

This dishwasher complies with current safety requirements. Inappropriate use can, however, lead to personal injury and damage to property.

To avoid the risk of accidents and damage to the dishwasher, please read the installation sheet and the operating instructions carefully before it is installed and used for the first time. They contain important information on its installation, safety, use and maintenance.

Keep the installation sheet and the operating instructions in a safe place and pass them on to any future owner.

Miele cannot be held liable for damage caused by non-compliance with this information.

Warning and Safety instructions

Correct application

- ▶ This dishwasher is intended for use in domestic households and similar working and residential environments.
- ▶ The dishwasher is not intended for outdoor use.
- ▶ It must only be used as a domestic appliance as specified in these operating instructions, for cleaning domestic crockery and cutlery. Any other usage is not supported by the manufacturer and could be dangerous.
- ▶ The appliance can only be used by people with reduced physical, sensory or mental capabilities, or lack of experience and knowledge, if they are supervised whilst using it, or have been shown how to use it in a safe way and recognise and understand the consequences of incorrect operation.

Safety with children

- ▶ Children under 8 years of age must be kept away from the appliance unless they are constantly supervised.
- ▶ Children 8 years and older may only use the dishwasher unsupervised if they have been shown how to use it safely and recognise and understand the consequences of incorrect operation.
- ▶ Children must not be allowed to clean or maintain the appliance unsupervised.
- ▶ Please supervise children in the vicinity of the dishwasher and do not let them play with it. There is a danger that children playing might shut themselves in the dishwasher.
- ▶ If the automatic door opening mechanism (depending on model) is active keep young children away from the area in which the door opens. Danger of injury in the unlikely event of a fault with the opening mechanism.
- ▶ Danger of suffocation. Packaging, e.g. plastic wrappings, must be kept out of the reach of babies and children. Whilst playing, children could become entangled in packaging or pull it over their head and suffocate.
- ▶ Keep children away from detergents. Dishwasher detergents can cause burning in the mouth, nose and throat if swallowed, or inhibit breathing. Keep children away from the dishwasher when the door is open. There could still be detergent residues in the cabinet. Seek medical attention immediately if your child has swallowed or inhaled detergent.

Warning and Safety instructions

Technical safety

- ▶ Unauthorised installation, maintenance and repairs can cause considerable danger for the user. Installation, maintenance and repairs must only be carried out by a Miele authorised technician.
- ▶ A damaged dishwasher is dangerous. Check it for any recognisable damage. Never install or attempt to use a damaged appliance.
- ▶ The electrical safety of this appliance can only be guaranteed when correctly earthed. It is essential that this standard safety requirement is met. If in any doubt, please have the electrical installation tested by a qualified electrician.
Miele cannot be held liable for the consequences of an inadequate earthing system (e.g. electric shock).
- ▶ Reliable and safe operation of this dishwasher can only be assured if it has been connected to the mains electricity supply.
- ▶ The dishwasher must only be plugged into the electricity supply via a suitable switched socket using a suitable fused plug (it must not be hard-wired). The electrical socket must be easily accessible after the dishwasher is installed so that it can be disconnected from the electricity supply at any time.
- ▶ There must be no electrical sockets behind the dishwasher.
Danger of overheating and fire risk if the dishwasher were to be pushed up against a plug.
- ▶ The dishwasher must not be installed under a hob. The high radiant temperatures which are sometimes generated by a hob could damage the dishwasher. For the same reason it should not be installed next to open fires or other appliances which give off heat, such as heaters etc.
- ▶ To avoid the risk of damage to the dishwasher, make sure that the connection data on the data plate (fuse rating, voltage and frequency) match the mains electricity supply before connecting the dishwasher to the mains. Consult a qualified electrician if in doubt.

Warning and Safety instructions

- ▶ Do not connect the dishwasher to the mains supply until it has been fully installed and any adjustment has been made to the door springs.
- ▶ The dishwasher may only be operated if the door opening mechanism is working correctly. Otherwise there could be a risk of danger whilst the automatic door opening mechanism (depending on model) is active.
To check that the door opening mechanism is working correctly:
 - the door springs must be adjusted equally on both sides. They are correctly adjusted when the door remains stationary when left half open (approx. 45° opening angle). It is also important that the door cannot fall open.
 - the door locking pins automatically retract when the door opens at the end of the drying phase.
- ▶ Do not connect the appliance to the mains electricity supply by a multi-socket adapter or an extension lead. These do not guarantee the required safety of the appliance (fire hazard).
- ▶ The appliance must not be used in a non-stationary location (e.g. on a ship).
- ▶ Do not install the dishwasher in a room where there is a risk of frost. Frozen hoses may burst or split. The reliability of the electronic control unit may be impaired at temperatures below freezing point.
- ▶ To avoid any damage to the appliance, the dishwasher must only be operated when it is connected to a fully vented plumbing system.
- ▶ The plastic housing of the water connection contains an electrical component. It must not be dipped in water.
- ▶ There are electrical wires in the water inlet hose. Do not shorten the water inlet hose, even if it is too long.

Warning and Safety instructions

- ▶ The integrated Waterproof system offers protection from water damage, provided the following conditions are met:
 - The dishwasher is correctly installed and plumbed in.
 - The dishwasher is properly maintained and parts are replaced where it can be seen that this is necessary.
 - the stopcock is turned off during longer absences from the home (e.g. whilst on holiday).

The Waterproof system will work even if the appliance is switched off. However, the appliance must remain connected to the electricity supply.

- ▶ The water pressure (flow pressure at the take-off point) must be between 50 and 1000 kPa (0.5 and 10 bar).
- ▶ If the dishwasher gets damaged, switch it off at the mains immediately and call your Miele Dealer or the Miele Service Department.
- ▶ While the appliance is under guarantee, repairs should only be undertaken by a Miele authorised service technician. Otherwise the guarantee is invalidated.
- ▶ Miele can only guarantee the safety of the appliance when genuine original Miele replacement parts are used. Faulty components must only be replaced by Miele spare parts.
- ▶ During installation, maintenance and repair work, the appliance must be disconnected from the mains electricity supply (switch it off and withdraw the plug from the socket).
- ▶ If the connection cable is damaged it must be replaced with a special cable of the same type (available from Miele). For safety reasons this work must be carried out by a Miele authorised service technician only.

Warning and Safety instructions

► This dishwasher is supplied with a special lamp to cope with particular conditions (e.g. temperature, moisture, chemical resistance, abrasion resistance and vibration). This special lamp must only be used for the purpose it is intended for. It is not suitable for room lighting. Replacement lamps may only be fitted by a Miele authorised person or the Miele Service Department.

Correct installation

► The dishwasher must be installed and connected in compliance with the installation sheet supplied.



► Take care, both before and during installation of the dishwasher, not to cut yourself on the metal parts. Danger of injury. Wear protective gloves.

► The dishwasher must be correctly aligned to ensure problem-free operation.

► In order to ensure stability, built-under and integrated dishwashers must only be installed under a continuous worktop which is secured to adjacent cabinetry.

► If you want to convert your freestanding dishwasher to a built-under ("U") model, you will need to order the appropriate conversion kit. If you remove the existing plinth, you must replace it with a U-model plinth. This is necessary to avoid the risk of injury caused by protruding metal parts.

► The door springs must be adjusted equally on both sides. They are correctly adjusted when the door remains stationary when left half open (approx. 45° opening angle). It is also important that the door cannot fall open.

The appliance may only be used with correctly adjusted door springs.

Warning and Safety instructions

Correct use

- ▶ Do not use solvents in the dishwasher. Danger of explosion.
- ▶ Do not inhale or ingest dishwasher detergent. Dishwasher detergents can cause burning in the nose, mouth and throat if swallowed, or inhibit breathing. Seek medical attention immediately if detergent has been swallowed or inhaled.
- ▶ You could injure yourself on the open dishwasher door or trip over it. Avoid leaving the door open unnecessarily.
- ▶ Do not sit or lean on the opened door. This could cause the dishwasher to tip and be damaged, and you could get injured.
- ▶ Dishes can be very hot at the end of the programme. Allow them to cool until they are comfortable enough to handle before unloading.
- ▶ Only use detergent and rinse aid formulated for domestic dishwashers. Do not use washing-up liquid.
- ▶ Do not use commercial or industrial detergents as these may cause damage, and there is a risk of a severe explosive chemical reaction (such as an explosive oxyhydrogen gas reaction).
- ▶ Do not fill the rinse aid reservoir with powder or liquid detergent. This will cause serious damage to the reservoir.
- ▶ Inadvertently filling the salt reservoir with powder or liquid dishwasher detergent will damage the water softener. Make sure you have picked up the correct packet of dishwasher salt before filling the salt reservoir!
- ▶ Only use special coarse grained dishwasher salt for reactivation. Do not use other salts such as cooking salt, agricultural grade or gritting salt. These may contain insoluble additives which can impair the functioning of the water softener.

Warning and Safety instructions

- ▶ In an appliance with a cutlery basket (depending on model), cutlery is cleaned and dried more efficiently if placed in the basket with the handles downwards. However, to avoid the risk of injury, place knives and forks etc. with the handles upwards.
- ▶ Plastic items which cannot withstand being washed in hot water, such as disposable plastic containers or plastic cutlery should not be cleaned in the dishwasher. The high temperatures in the dishwasher may cause them to melt or lose shape.
- ▶ If you use the "FlexiTimer/Delay start" option (depending on model), make sure that the dispenser is dry before adding detergent. Wipe dry if necessary. Detergent will clog if poured into a damp dispenser and may not be thoroughly dispersed.
- ▶ Please observe the information given in "Technical data" regarding the capacity of the dishwasher.

Accessories

- ▶ Only use genuine original Miele accessories and spare parts with this appliance. Using accessories or spare parts from other manufacturers will invalidate the guarantee, and Miele cannot accept liability.

Disposal of your old dishwasher

- ▶ Make the door lock inoperative so that children cannot accidentally shut themselves in. Make appropriate arrangements for the disposal of the appliance.

Caring for the environment

Disposal of the packing material

The packaging is designed to protect the appliance from damage during transportation. The packaging materials used are selected from materials which are environmentally friendly for disposal and should be recycled.

Recycling the packaging reduces the use of raw materials in the manufacturing process and also reduces the amount of waste in landfill sites.

Disposing of your old appliance

Electrical and electronic appliances often contain valuable materials. They also contain specific materials, compounds and components, which were essential for their correct function and safety. These could be hazardous to human health and to the environment if disposed of with your domestic waste or if handled incorrectly. Please do not, therefore, dispose of your old appliance with your household waste.



Please dispose of it at your local community waste collection / recycling centre for electrical and electronic appliances, or contact your dealer or Miele for advice. You are also responsible (by law, depending on country) for deleting any personal data that may be stored on the appliance being disposed of. Please ensure that your old appliance poses no risk to children while being stored prior to disposal.

Energy saving washing

This dishwasher is exceptionally economical in its use of water and electricity.

You can make the most of your appliance by following these tips:

- For most economical dishwashing, make full use of the baskets without overloading the dishwasher.
- Choose the programme to suit the type of crockery being washed and the degree of soiling.
- Select the ECO programme (depending on model) for energy-saving dishwashing. This programme is the most efficient in terms of its combined energy and water consumption at cleaning normally soiled crockery.
- If your dishwasher is connected to a hot water supply select the SolarSave programme for washing a lightly to normally soiled load. Because the water is not heated in this programme, crockery may still be slightly damper at the end of this programme than it would be with other programmes.
- Follow the detergent manufacturer's recommendations on detergent dosage.
- When using powder or liquid detergent you can use $\frac{1}{3}$ less detergent if baskets are only half full.

Caring for the environment

EcoFeedback consumption indicator

The **Consumption** function is used for calling up information about the energy and water consumption of your dishwasher (see "Settings menu, Consumption").

Three different types of information can be displayed:

- an estimate of the consumption before the programme begins
- the actual consumption at the end of the programme
- the total consumption of the dishwasher

1. Consumption estimate:

The estimated energy and water consumption for a programme can be shown in the display.

- Open the door.
- Select the programme you want.
- Select the **Estimated consumption** option.

The estimated energy and water consumption will appear in the display.

The estimated consumption levels will be displayed as a bar chart. The more bars (■■■) in the display, the more energy or water will be used.

The values are influenced by the programme selected and any programme options selected.

The consumption indicator is switched on as standard. However, you can also switch the indicator off (see "Settings menu, Consumption").

2. Actual consumption

At the end of the programme you can call up the actual amount of energy and water used by the programme which has just been run.

- Open the door at the end of the programme.
- Press the **i** sensor.

Switching the dishwasher off at the end of the programme will delete the actual consumption values for the programme which has just been run.

3. "Consumption" setting

The **Consumption** setting gives a total of the energy and water which has been used in all previous dishwasher programmes (see "Settings menu, Consumption").

Opening the door

This dishwasher has a motorised door opener which is activated by knocking on the door front ("Knock2open function").

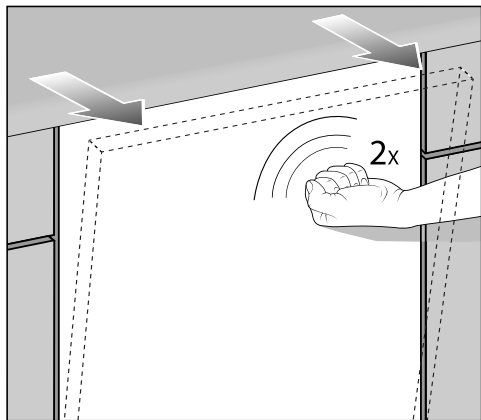

- Knock twice in quick succession on the top third of the door front

The door will open a little.

- There are two dark grips inside the door at the top. Take hold of them and pull to release the door lock.

The door locking pins will retract.

If the door is opened during operation all functions are automatically interrupted.

The number of knocks required for opening the door can be changed if wished (see "Settings, Knock2open").

⚠ Water in the dishwasher may be hot. Danger of scalding.

Only open the door during operation if absolutely necessary and exercise extreme caution when doing so.

⚠ Keep the area around the door free of obstructions.

At the end of programmes with a drying phase (see "Programme chart"), the door will open automatically a little in order to help the drying process. This function can be deactivated, if preferred (see "Settings menu, AutoOpen").

Before using for the first time

Emergency door opener

If the door will not open when knocked or if there is a power cut the door can be opened manually with the Knock2open device supplied with the dishwasher.

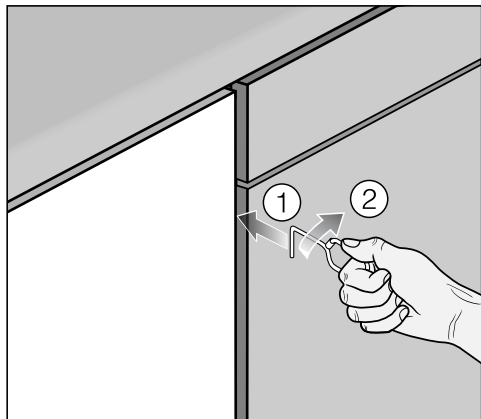

- Push the device into the gap between the dishwasher front and the neighbouring unit door about 15 cm below the worktop.
- Turn the device clockwise ②, until it grips behind the dishwasher front.

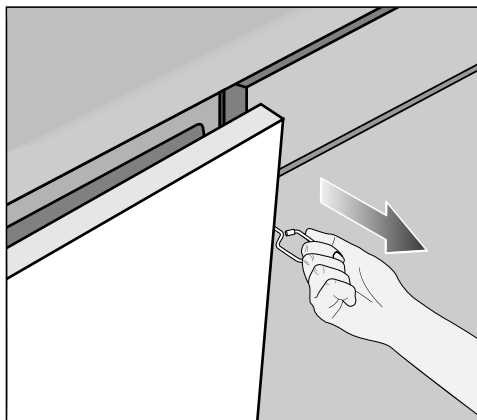

- Then use it to pull the door open.

Closing the door

- Push the baskets right in.
- Raise the door upwards until the catch engages.

The door will then close automatically.



Danger of injury.

Do not put your hand inside the door as it is closing.

Basic settings

- Open the door.
- Switch the dishwasher on using the ① sensor.

The welcome screen will appear when the dishwasher is switched on for the first time.

Language

The display will then change automatically to the screen for setting the language.

- Use the \vee/\wedge arrows to select the language you want and also the country, if applicable, and confirm your selection with OK.

See "Guide to the appliance, Display" for more information about the display and controls.

A tick ✓ will appear next to the language that has been set.

Time of day

The display will then change to the screen for setting the time.

The current time of day must be set before you can use the Delay start option.

- Use the \vee/\wedge arrows to set the hour and confirm with OK.
- Then set the minutes and confirm with OK.

Keeping the relevant sensor pressed in, will increase or decrease the time automatically.

Before using for the first time

Water hardness

The display will change to the screen for setting the water hardness.

- The dishwasher must be programmed to the correct water hardness for your area.
- Your local water authority will be able to advise you of the water hardness level in your area.
- Where the water hardness fluctuates e.g. between 1.8 and 2.7 mmol/l (10 - 15 °d - German scale) always programme the dishwasher to the higher value (2.7 mmol/l or 15 °d in this example).

In the event of a fault, it will help the service technician if you know the hardness of your local water supply.

Enter the water hardness below:

_____ mmol/l or °d

The dishwasher is programmed at the factory for a water hardness level of 2.7 mmol/l (15 °d - German scale).

- Use the \vee/\wedge arrows to select the hardness you want and confirm with OK.

See "Settings menu, Water hardness" for more information.

Finally, prompts will appear in the display.

After confirming these with OK, both the S and * indicators will light up.

- Add salt and rinse aid if necessary (see "Before using for the first time", "Dishwasher salt" and "Rinse aid").
- Confirm the messages with OK.

The display will change to show the main menu.

Before using for the first time

Before using the appliance for the first time, you require:

- approx. 1 kg dishwasher salt,
- domestic dishwasher detergent,
- rinse aid formulated for domestic dishwashers.

Every dishwasher is tested at the factory. There will be residual water in the appliance from this test. It is not an indication that it has been used previously.

Dishwasher salt

In order to achieve good cleaning results, the dishwasher needs to operate with soft water. Hard water results in a build-up of calcium deposits on crockery and in the dishwasher.

Mains water with a hardness level higher than 0.7 mmol/l (4 °d - German scale) needs to be softened. This takes place automatically in the integrated water softener. The water softener in the dishwasher is suitable for a water hardness level of up to 12.6 mmol/l (70 °d - German scale).

The water softener requires dishwasher salt.

Depending on the water hardness level (< 3.8 mmol/l, or 21 °d - German scale), dishwasher salt is not required if combination tablets are being used (see "Operation, Detergent").

If the water in your area is very soft and constantly **lower than 0.9 mmol/l (5 °d - German scale)** you do **not** have to add dishwasher salt. The prompt to add salt will be switched off automatically if the water softener has been programmed for this to happen.



Dishwasher detergent will damage the water softener.

Do not fill the salt reservoir with powder or liquid detergent.



Only use special coarse grained dishwasher salt for reactivation.

Other salts may contain insoluble additives which can impair the functioning of the water softener.

Before using for the first time

Adding salt

- When filling the salt reservoir **only open the door halfway** to ensure that all the salt gets into the reservoir.

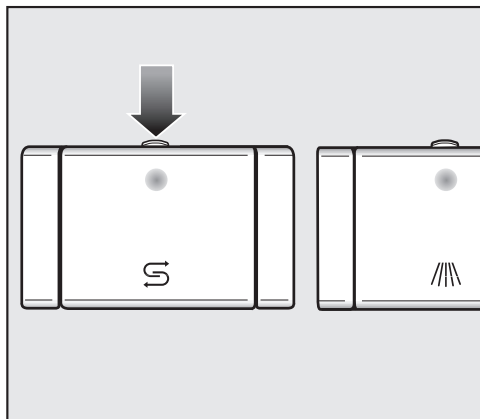

- Press the button on the top of the salt reservoir in the direction of the arrow.

The flap will spring open.

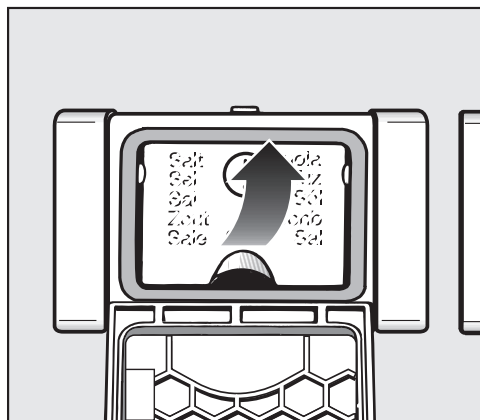

- Lift up the funnel.

Do **not** fill the reservoir with water.

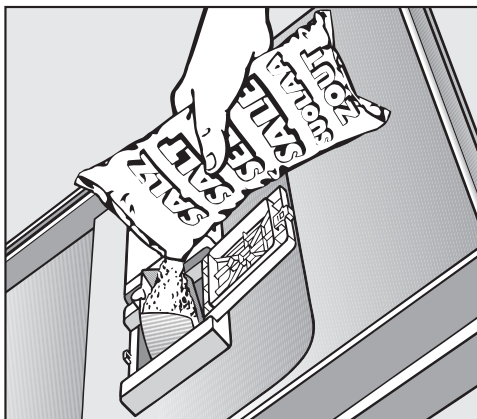

- Add salt only until the reservoir is full or until water runs out of the opening. The salt reservoir holds approx. 1 kg of salt, depending on the brand used.

Do not add any more than 1 kg of salt.

As the salt reservoir is filled, displaced water may overflow.

- Clean any excess salt from around the reservoir opening, and then close the flap.
- Immediately after filling the salt reservoir, run the *QuickPowerWash* programme with the *Short* option and without any crockery in the dishwasher to dissolve and remove any traces of salt from the cabinet.

Add salt reminder

- When  Insufficient salt appears in the display wait until the end of the programme and then refill the salt reservoir.

- Confirm with *OK*.

The message will go out.



Risk of corrosion.

Immediately after filling the salt reservoir, run the QuickPowerWash programme with the Short programme option selected and without any crockery in the dishwasher to remove any traces of salt from the cabinet.

If you only ever use combination products containing salt and rinse aid in your dishwasher, you can switch the reminders off if you wish (see "Settings menu, Refill reminders").

If you switch to using detergent that does not contain salt or rinse aid, it is important to remember to add salt and rinse aid and to switch the reminders back on.

After the salt reservoir has been filled, the refill reminder may still appear in the display if the salt concentration has not yet reached the correct level. If this is the case, confirm again with *OK*.

The refill reminder will be switched off if you have programmed the dishwasher for a water hardness below 0.9 mmol/l (5 °d - German scale).

Before using for the first time

Rinse aid

Rinse aid is necessary to ensure water does not cling and leave marks on crockery during the drying phase and helps crockery dry faster after it has been washed.

Rinse aid is poured into the storage reservoir and the amount set is dispensed automatically.

⚠ Inadvertently filling the rinse aid reservoir with washing-up liquid or powder or liquid detergent will damage the reservoir. Only pour rinse aid formulated for domestic dishwashers into the reservoir.

Alternatively, it is possible to use

- Household vinegar with a max. 5% acid content
- or
- Liquid citric acid up to 10% acid content

The resulting rinsing and drying quality will not, however, be as good as when rinse aid is used.

⚠ Do not use vinegar with a higher acid content (e.g. vinegar essence 25% acid). This would damage the dishwasher.

If you only ever use combination products containing rinse aid in your dishwasher, you do not need to add rinse aid.

Adding rinse aid

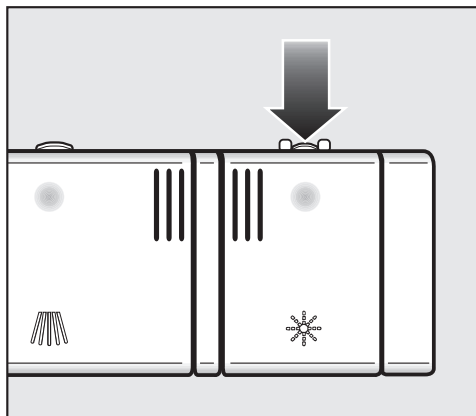

- Press the button on the lid of the rinse aid reservoir in the direction of the arrow until the flap springs open.

Before using for the first time

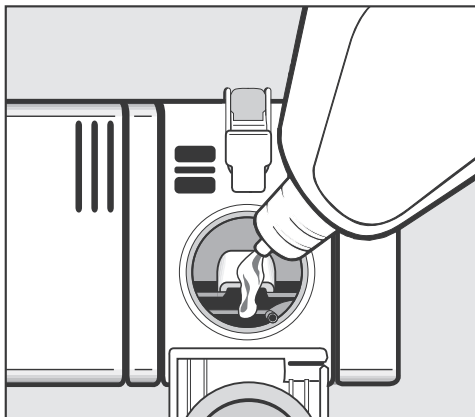

- Add rinse aid only until it is visible in the opening.

The rinse aid reservoir holds approx. 110 ml.

- Close the flap firmly so that it clicks into place. Otherwise water can enter the rinse aid reservoir during a programme.
- Wipe up any spilled rinse aid. This prevents over-foaming occurring during the next programme.

You can adjust the rinse aid dosage for best results (see "Settings menu, Rinse aid").

Add rinse aid reminder

When the ☼ Insufficient rinse aid message appears, the reservoir contains sufficient rinse aid for 2 - 3 programmes only.

- Add rinse aid in plenty of time.
- Confirm with OK.

The message will go out.

If you only ever use combination products containing salt and rinse aid in your dishwasher, you can switch both reminders off if you wish (see "Settings menu, Refill reminders").

If you switch to using detergent that does not contain salt or rinse aid, it is important to remember to add salt and rinse aid and to switch the reminders back on.

Loading the dishwasher

Notes

Remove coarse food residues from crockery.

There is no need to rinse items under running water.

 Do not wash items soiled with ash, sand, wax, lubricating grease or paint in the dishwasher. These will damage to the dishwasher.

Crockery can be loaded anywhere in the baskets, but the following notes should be observed:

- Do not place crockery and cutlery inside other pieces where they may be concealed.
- Load the crockery so that water can access all surfaces. This ensures that they get properly cleaned.
- Make sure that all items are securely positioned.
- Hollow items such as cups, glasses, pans, etc. must be inverted in the basket.
- Tall, narrow, hollow items, e.g., champagne glasses, should be placed in the centre of the basket to ensure better water coverage.
- Wide based items should be placed at an angle so that water can run off them freely.
- The spray arms must not be blocked by items which are too tall or hang through the baskets. If in doubt, test for free movement by manually rotating the spray arms.

- Make sure that small items cannot fall through the holders in the baskets.
Small items, e.g. lids, should therefore be placed in the cutlery tray or cutlery basket (depending on model).

Some foodstuffs may contain natural dyes, e.g. carrots, tomatoes or ketchup. Plastic items in the dishwasher may discolour if large quantities of these foodstuffs find their way into the dishwasher on the crockery. The stability of plastic items is not affected by this discolouration.

Cleaning silver cutlery in the dishwasher may also cause plastic items to discolour.

Items not suitable for dishwashers:

- Wooden cutlery and crockery or items with wooden parts: these may discolour and fade. The glue used in these items is not dishwasher-proof and wooden handles may come loose after being washed in a dishwasher.
- Craft items, antiques, valuable vases and decorative glassware: such items are not suitable for dishwashers.
- Plastic items which are not heat resistant: the high temperatures in the dishwasher may cause them to melt or lose shape.
- Copper, brass, tin and aluminium items: these may discolour or become matt.
- Colours painted over a glaze: these may fade after a number of washes.
- Delicate glassware and glassware containing lead crystal: clouding may occur over time.

Please note

Silverware previously cleaned with a **silver polish** may still be damp or spotted at the end of a programme, where water has not run off smoothly. It may need to be rubbed dry with a soft cloth.

Silver which has been in contact with foods containing sulphur can discolour. These include egg yolk, onions, mayonnaise, mustard, pulses, fish, fish brine and marinades.

 Aluminium components (e.g. cooker hood grease filters) must not be cleaned with caustic alkaline commercial or industrial cleaning agents.

These may damage the material, or in extreme cases, there is a risk of a severe explosive chemical reaction (such as an explosive oxyhydrogen gas reaction).

Tip: When purchasing new crockery and cutlery, make sure they are dishwasher-proof.

Glass care

- Clouding may occur on glasses after frequent washing. If delicate glassware is washed in the dishwasher ensure that only very low temperatures are used (see programme chart), or a special glass-care programme is used (depending on model). This will reduce the risk of clouding.
- Purchase glassware which is dishwasher safe (e.g. Riedel glassware).
- Use detergents with glass protective additives.
- Visit "<http://www.miele-glasscare.com/international/en/glasscare/english>" for more information on glass care.

Loading the dishwasher

FlexAssist

The yellow coded FlexAssist parts indicate which elements of the dishwasher baskets and cutlery tray are moveable. They also act as grips and have symbols embossed on them to show what the moveable parts are used for.

Upper basket

See "Loading the dishwasher, Loading examples" for examples of how to load crockery and cutlery.

 For safety reasons, do not operate the dishwasher without the upper and lower baskets in place (except when running the Tall items programme, if available).

- Use the upper basket for small, lightweight and delicate items such as cups, saucers, glasses, dessert bowls, etc.
Shallow pans or casserole dishes can also be placed in the upper basket.
- Long items such as soup ladles, mixing spoons and long knives should be placed lying down across the front of the upper basket.

Cup rack

- Raise the rack upwards using the yellow lever  to make room for tall items.

Glasses can be arranged along the cup rack for support during the programme.

- Lower the cup rack and lean the glasses against it.

Loading the dishwasher

Hinged spikes

The rows of spikes can be lowered to make more room for larger items such as casserole dishes.

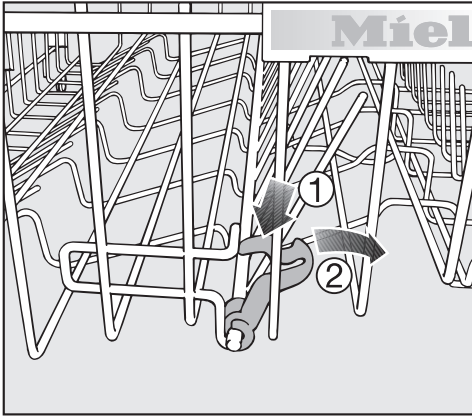

- Press the yellow lever downwards ① and then lower the spikes ②.

Jumbo cup rack (depending on model)

The cup rack can be set at two different widths so that it can also accommodate large cups.

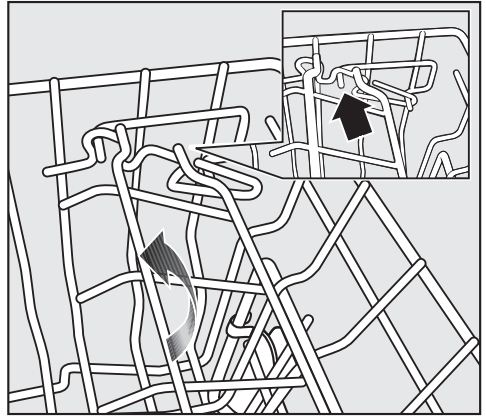



- Pull the cup rack upwards and click it back into position at the required width.

Loading the dishwasher

Glass rail

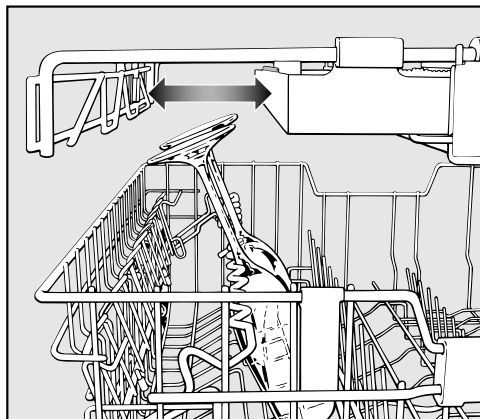
This rail is designed to hold tall glasses and stemware securely.



- Lower the rail with the yellow lever  and lean tall glasses against it.
- You can also move one of the side inserts in the cutlery tray to make more room for tall glasses (see "Cutlery, 3D cutlery tray").

Adjusting the height

You can set the glass rail at two different heights.

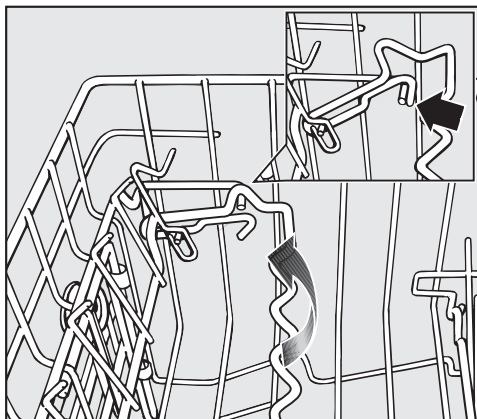

- Pull the rail upwards and click it back into position at the required height.

Use the low setting for small glasses and tumblers.

Use the high setting for tall glasses and stemware.

Loading the dishwasher

Adjusting the upper basket

In order to gain more space for taller pieces of crockery in the lower or upper basket, the upper basket can be adjusted on three levels with 2 cm between each level.

The upper basket can also be set at an angle with one side high and the other side low. This can be useful to help prevent water being left in deep dishes etc. Ensure, however, that the basket can be inserted smoothly into the cabinet. It is better to adjust the basket before loading it.

- Pull out the upper basket.

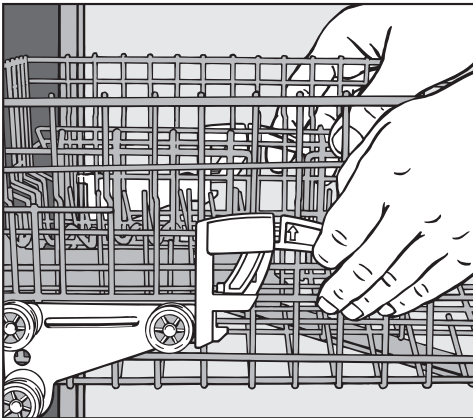

To raise the upper basket:

- Lift the basket up until it clicks into place.

To lower the upper basket:

- Pull upwards on the levers at either side of the upper basket.
- Adjust the basket to the desired height and then push the levers securely back down into position.

Depending on the setting of the upper basket, the following plate dimensions can be accommodated.

Dishwashers with cutlery basket

(see data plate for model number)

Upper basket level	Plate Ø in cm		
	Upper basket		Lower basket
	Stand-ard	XXL	
Top	20	24	31 (35*)
Middle	22	26	29
Bottom	24	28	27

Dishwashers with cutlery tray

(see data plate for model number)

Upper basket level	Plate Ø in cm		
	Upper basket		Lower basket
	Stand-ard	XXL	
Top	15	19	31 (35*)
Middle	17	21	29
Bottom	19	23	27

* When tilted, plates of up to 35 cm can be accommodated (see "Lower basket).

Loading the dishwasher

Lower basket

See "Loading the dishwasher, Loading examples" for examples of how to load crockery and cutlery.

- Use the lower basket for larger and heavier items such as plates, serving platters, saucepans, serving dishes, etc.

Glasses, cups and small items such as saucers can also be placed in the lower basket.

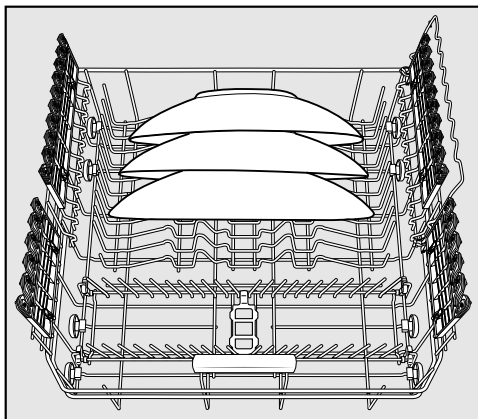

- Place very large plates in the centre of the lower basket.

When tilted, plates up to 35 cm in diameter can be accommodated.

Removable MultiComfort insert

The rear section of the lower basket is used for washing cups, glasses, plates and pots.

You can remove the MultiComfort insert to make more room for larger items such as pans and casserole dishes.

To remove the insert

- Pull the yellow handle forwards and remove the insert.

To replace the insert

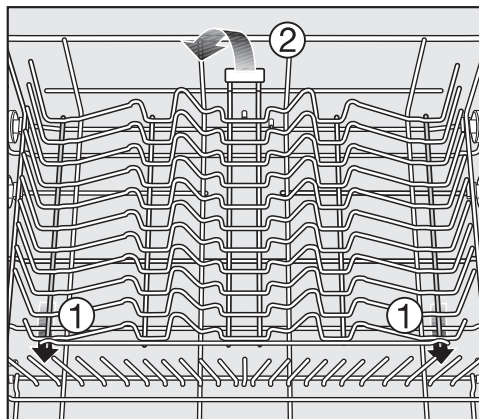

- Fit the insert into the lower basket with the hooks going under the long cross-piece ①.
- Press down on the insert until it clicks into position ②.

Loading the dishwasher

FlexCare glass holder

Silicone padding in the FlexCare glass holder provides a stable and secure hold for delicate stemware.

- Stemware, e.g. wine glasses, champagne flutes and beer glasses, can be leaned against the glass rack or suspended from it.
- The glass rack can be raised to make more room for tall items.

You can set the glass rack at two different heights.

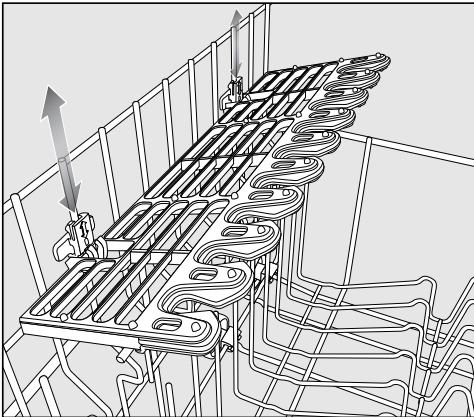

- Slide the glass rack to the desired height until the catches click into place at the top or rest on the bottom.

Glass rail

This rail is designed to hold tall glasses and stemware securely.

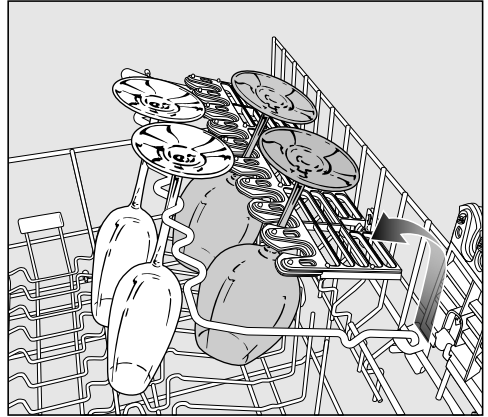

- Lower the rail and lean tall glasses against it.

Loading the dishwasher

Hinged spikes

The spikes at the front are used for washing plates, soup bowls, platters, dessert bowls, and saucers.

Both rows of spikes can be lowered to make more room for large items, e.g. pots, pans and serving dishes.

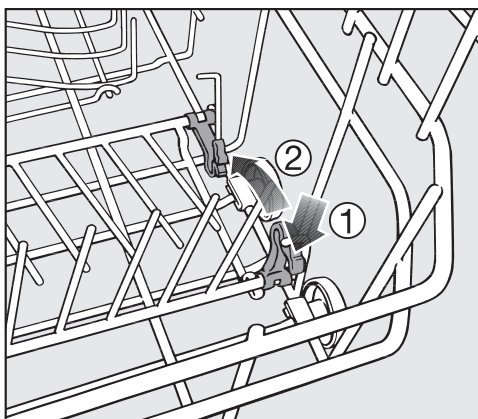

- Press the yellow lever downwards ①, and then lower the spikes ②.

Bottle holder

The bottle holder can be used to wash narrow items, e.g. milk and baby bottles.

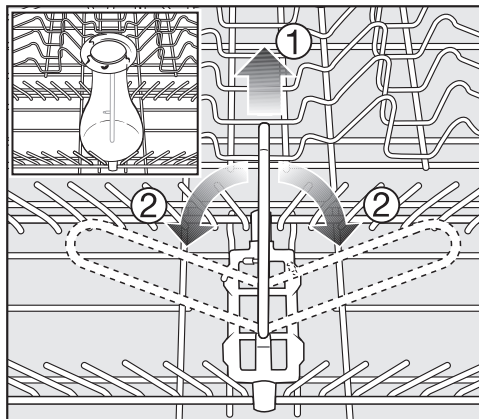

- If the bottle holder is not needed, lift it up ① and fold the sides down ②, as illustrated.

Loading the dishwasher

Cutlery

3D Cutlery tray + (depending on model)

See "Loading the dishwasher, Loading examples" for examples of how to load crockery and cutlery.

- Arrange the cutlery in the tray as shown.

To make unloading easier, cutlery should be grouped in zones, one for knives, one for forks, one for spoons, etc.

Spoon heads should be placed in contact with at least one of the serrated retainers on the base of the cutlery tray to ensure that water runs off them freely.

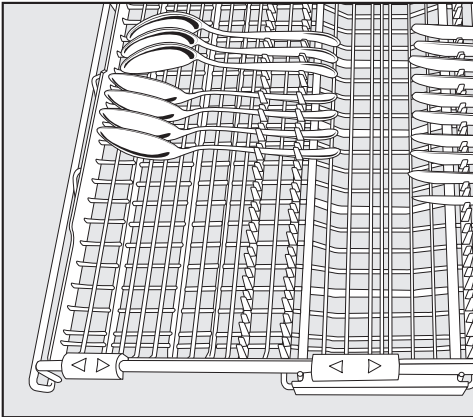

For optimum cleaning results arrange spoons with the inner part facing the centre of the cutlery tray.

The upper spray arm must not be blocked by items which are too big (e.g. cake slices).

The side sections of the tray can be moved into the middle using the yellow grips in order to accommodate tall items of crockery in the upper basket (see also "Upper basket, glass rail").

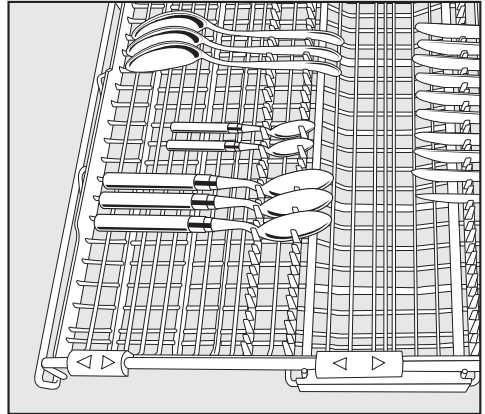

If spoon handles do not fit between the holders, then lay them the other way round.

Loading the dishwasher

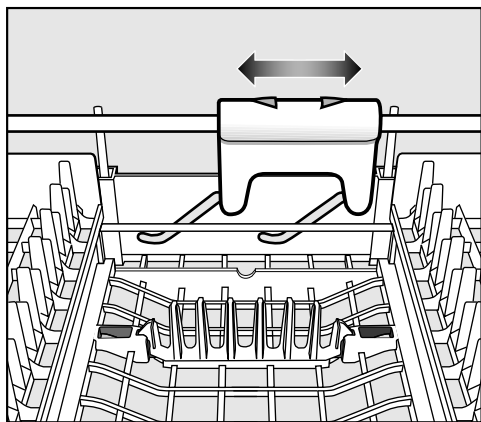

You can use the yellow slide to adjust the height of the middle section of the cutlery tray to make more room for large items of cutlery, such as serving spoons and ladles.

Both rows of spikes in the middle section of the cutlery tray can be flipped over to make room for larger pieces of cutlery.

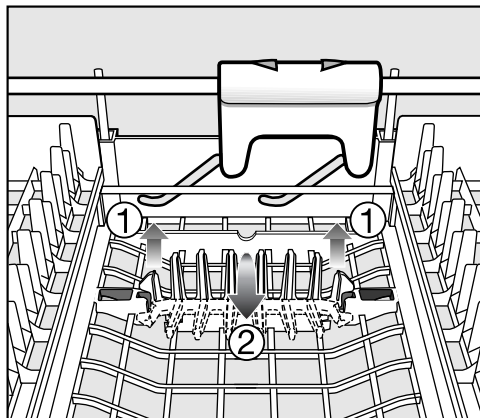

- Raise the spikes ① and then flip them over ②.

Loading examples

Dishwashers with cutlery tray

Upper basket

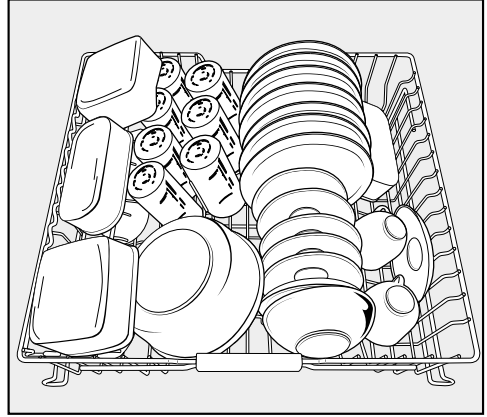
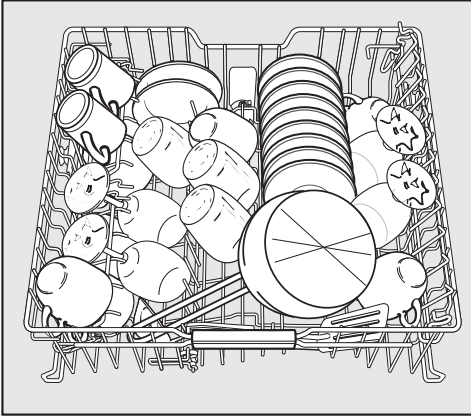

Lower basket

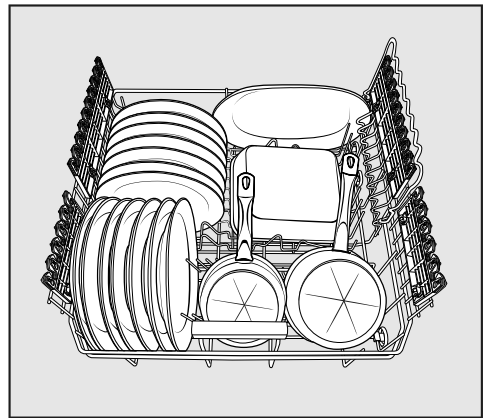
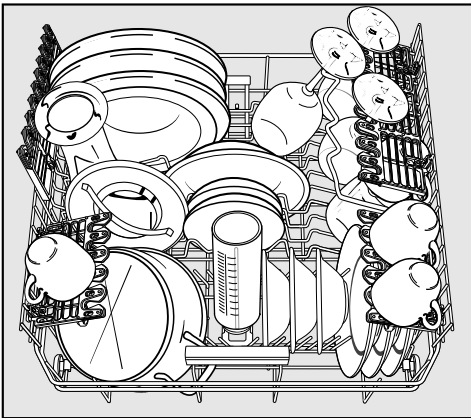

Loading the dishwasher

Cutlery tray

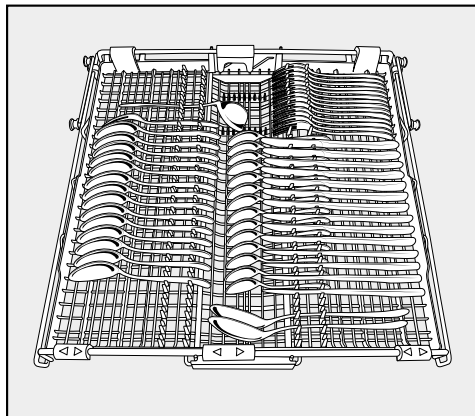
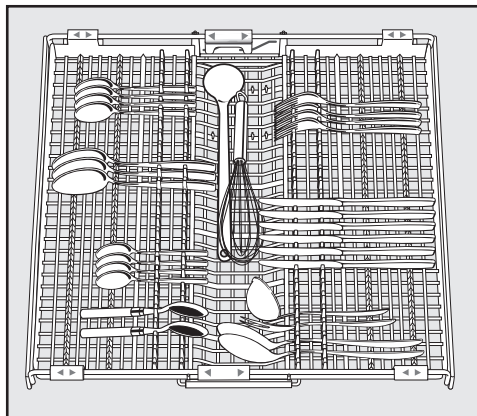

Heavily soiled items

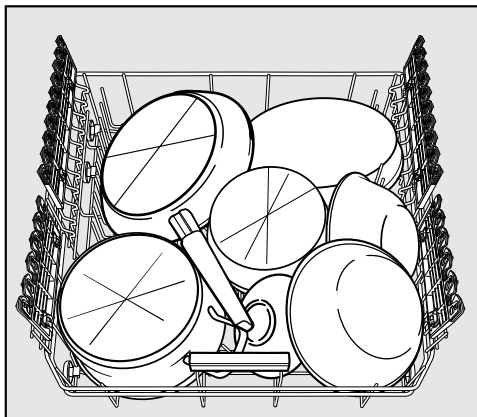

Detergent

 Only use detergents formulated for domestic dishwashers. Do not use washing-up liquid.

Active ingredients

Modern detergents contain various active ingredients, the most important of which are:

- Complexing agents to prevent calcification.
- Alkalis to aid removal of dried on soiling.
- Enzymes to break down starch and loosen protein.
- Oxygen based bleaching agents to remove coloured stains (e.g. tea, coffee, tomato sauce).

Most dishwasher detergents are mildly alkaline and contain enzymes and oxygen based bleaching agents.

Types of detergent:

- Powder and liquid gel detergents.
These detergents allow you to adjust the amount dispensed according to the size of the load and level of soiling.
- Tab detergents. These are suitable for most levels of soiling.

You can also buy combination products (see "Programme options, DetergentAgent", if applicable).

In addition to detergent, these products contain rinse aid and salt substitutes. They are available as "3 in 1" or when they also contain other components such as glass and stainless steel protective additives and enhanced cleaning power, as "5 in 1", "7 in 1", "All in 1" etc.

Refer to the manufacturer's packaging as to whether combination products are suitable for the water hardness level in your area.

Please note that the cleaning and drying results of combination detergents can vary greatly.

For optimum cleaning and drying results, use Miele dishwasher detergent and add Miele salt and Miele rinse aid separately. See "Optional accessories".

Operation

Detergent dosage

- Follow the dosage recommended by the manufacturer on the packaging.
- Unless directed otherwise, use one detergent tab or add 20 to 30 ml detergent to compartment II, depending on the level of soiling. With very heavy soiling you can also add a small amount of detergent to compartment I.
- Tabs may not dissolve completely when the QuickPowerWash programme (if available) is used.

Failure to dispense the recommended amount of detergent may impair cleaning results.

 Dishwasher detergents can cause burning in the nose, mouth and throat if swallowed, or inhibit breathing.

Avoid inhalation of powder detergents and do not ingest dishwasher detergent. Seek medical attention immediately if detergent has been swallowed or inhaled.

Keep detergent out of the reach of children at all times. Keep children away from the dishwasher when the door is open. There could still be detergent residues in the cabinet. Only add detergent just before starting the programme and close the door, activating the safety lock (if your dishwasher is fitted with one).

Adding detergent

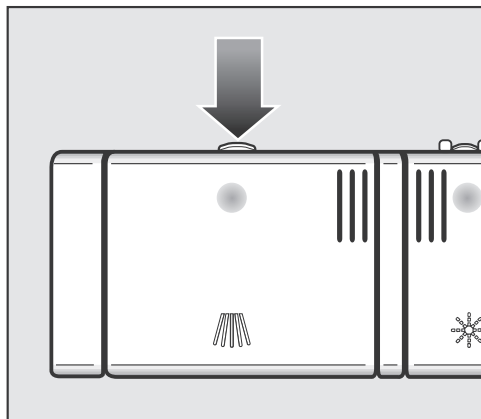

- Press the opening catch on the detergent dispenser. The flap will spring open.

The flap is always open at the end of a programme.

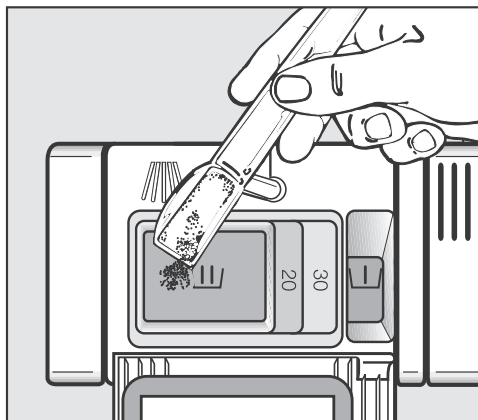

- Add the required amount of detergent and close the flap.
- Make sure that the detergent packaging is properly closed after use to avoid it getting damp and clumping together.

For information

Compartment I holds max. 10 ml,
Compartment II holds max. 50 ml of detergent.

There are marks in compartment II to assist with dispensing: 20, 30. The marks indicate a level of approx. 20 or 30 ml when the door is open in a horizontal position.

Operation

Switching on

- Open the stopcock, if it is closed.
- Open the door.
- Make sure the spray arms can rotate freely.
- Switch the dishwasher on using the ⓘ sensor.

The main menu will appear in the display.

Switch the **Memory** function on (see "Settings menu, Memory") if you want the last programme used to appear in the display instead of the main menu.

Selecting a programme

Choose your programme according to the type of load and how dirty it is.

The different programmes and their uses are described in the **Programme chart** later on in this booklet.

- Use the ∨∧ arrow buttons to select a programme and confirm with the OK button.

The display will change to show the programme menu.

Touch the ⓘ sensor to access more information about the programme currently selected.

You can now select extra options for your programme (see "Programme options").

To select a different programme, touch the ↵ sensor to return to the main menu.

Starting the programme

- Start the programme by closing the door.

The TimeControl indicator will light up to let you know the programme has started.

If you open the door the message Crockery can be added will show in the display.

As long as this message is showing, crockery can be added without compromising wash results.

 Water in the dishwasher may be hot. Danger of scalding from water in the cabinet.

Make sure you open the door very carefully.

A programme should only be cancelled in the first few minutes, if at all. Otherwise important programme stages could be omitted.

Time display

The estimated duration of the programme selected appears the display before the programme begins. During the programme, the time left until the end of the programme is displayed.

Symbols appear to indicate which stage the programme is at:

 Pre-wash / Soak

 Main wash

 Interim rinse

 Final rinse

 Drying

 Finish

The programme duration displayed may vary with the same programme. It is influenced by, among other things, the water temperature at each intake, the reactivation process, the water softening unit, the type of detergent, the amount of crockery and how dirty it is.

When a programme is selected for the first time, the display will show the average programme duration for a cold water intake.

The durations shown in the Programme chart refer to standard test loads and temperatures.

Each time a programme is run, the electronic unit calculates the programme duration required according to the temperature of the water taken into the dishwasher and the amount of crockery.

Operation

TimeControl

The TimeControl indicator light lets you know how much longer the programme has to run with the door shut.

All four indicator lights under the work-top will come on when the programme starts. They will go out one after the other from left to right in 20 minute intervals an hour before the end of the programme to let you know how long the programme still has left to run.

- 4 indicator lights:
Programme start / Time remaining exceeds 60 minutes
- 3 indicator lights:
Time remaining 60-41 minutes
- 2 indicator lights:
Time remaining 40-21 minutes
- 1 indicator light:
Time remaining 20-1 minute
- All indicators off:
The programme has finished

Energy management

To save energy, the dishwasher will switch off automatically 10 minutes after the last time a sensor has been pressed or after the end of the programme (see "Settings, Optimise standby").

- Press the ① sensor to switch the dishwasher back on.

The dishwasher will not switch off whilst a programme is running, during the Delay start period or if there is a fault.

At the end of the programme

At the end of a programme, the Time-Control indicator light will go out with the door shut. The buzzer might also be sounding.

The programme has finished when Finished appears in the display and the door has opened slightly (if applicable).

In the QuickPowerWash programme the door will not open until a few minutes after the programme has finished.

If the Consumption programmable function is switched on (see "Settings, Consumption") you can now view the actual energy and water consumption of the programme which has just finished

The drying fan may continue to run for a few minutes at the end of the programme.

You can now empty the dishwasher.

 If you have deactivated the automatic door opening function (see "Settings menu, AutoOpen"), but would still like to open the door at the end of the programme, then make sure that you open the door fully.

Otherwise steam from the dishwasher could damage the edge of the worktop because the fan is no longer running.

Operation

Switching off

At the end of a programme:

- Open the door.
- The dishwasher can be switched off at any time using the ⓘ sensor.

Switching the dishwasher off during a programme stops the programme.

Switching the dishwasher off during the run-up to a delay start time will also stop the process.

If the dishwasher is not going to be used for a longer period of time, e.g. whilst on holiday, the stopcock should be closed.

Unloading the dishwasher

Dishes tend to break and chip more easily when they are hot. Allow the dishes to cool until they are comfortable enough to handle before unloading them.

If you open the door fully after switching off, the dishes will cool much faster.

First unload the lower basket, then the upper basket and finally the cutlery tray (depending on model).

This will prevent water drops from the upper basket and cutlery tray from falling onto the dishes in the lower basket.

Interrupting a programme

A programme is interrupted as soon as the door is opened.

If the door is closed again, the programme will continue from the point it was at before the door was opened.

 Water in the dishwasher may be hot. Danger of scalding.

Only open the door if absolutely necessary and exercise extreme caution when doing so. Before closing the door again, leave it ajar for approx. 20 seconds. This will enable the temperature in the wash cabinet to settle. Then raise the door up and push until the catch engages.

Changing a programme

If the detergent dispenser flap has already opened, do not change the programme.

If a programme has already started and you wish to change it, proceed as follows:

- Open the door.
- Press the Back sensor .
- Confirm the message *Cancel programme?* with **Yes**.

The programme will be cancelled.

- Select the Main menu option.

The display will revert to the main menu.

- Select the programme you want, and then start it by shutting the door.

The in-operation indicator comes on to show that a programme has been started.

Programme options

Extras

Extras can be selected for the programme you have chosen before starting it.

- Open the door.
- Switch the dishwasher on using the ① sensor.
- Select a programme.
- Select the Extras option.

All available Extras will be shown in the display.

- Select the Extras you want using the OK sensor.

A tick ☒ will appear beside the Extra to show that it has been set.

Extras that cannot be combined will have a lock symbol  next to them.

- To deselect an Extra that you have chosen simply select OK again.
- When you have finished selecting Extras, confirm with Accept.

The display will change back to the programme menu.

The number of Extras selected will appear in the programme menu.

You can save the selected Extras for the respective programme (see "Settings, Save extras").

Short

The Short Extra reduces the duration of the programmes in which this option is available by up to 30% (see "Programme chart").

The selection of the Short Extra may take precedence over other selected Extras.

In order to achieve optimum cleaning results energy consumption may increase slightly with this option.

When used in combination with the QuickPowerWash programme, the Short Extra results in a wash programme without drying or automatic opening of the door.

Energy save

The Energy save Extra reduces the energy consumption of programmes in which this option is available by up to 20%.

In order to achieve optimum cleaning results the programme duration is extended with this option.

Intensive lower basket

The Intensive lower basket Extra intensifies cleaning performance in the lower basket in programmes in which this option is available.

Energy and water consumption are increased slightly due to the extended wash duration in the lower basket.

Extra dry

The Extra dry Extra improves the drying performance in programmes in which this option is available.

Energy consumption is increased due to an extended fan running time and an increased final rinse temperature.

Soak

The Soak Extra is used for soaking crockery with dried on soiling.

Energy and water consumption will increase with this Extra.

If you are using powder dishwasher detergent, add approx. 5 g to compartment I.

Pre-wash

The Pre-wash Extra can be used for removing easily soluble soiling from crockery.

Adding a pre-wash will increase the programme duration and increase energy and water consumption levels.



Programme options

Delay start

There are three ways of starting the programme by means of delaying the start. You can set the start time or the finish time of a programme. You also have the option of taking advantage of time variable economy rates of electricity using the EcoStart or SmartStart function.

When using the Delay start function, make sure that the detergent compartment is dry before adding detergent. Wipe dry with a cloth if necessary. If the compartment is wet, powder detergent can become lumpy and stick to the dispenser, with the result that it is not fully dispensed.

Do not use liquid detergent when selecting Delay start, as it can run into the dishwasher before it is required.

- Open the door.
- Switch the dishwasher on using the  sensor.
- Select the programme you want from the main menu.
- Press the  button.



The  indicator will light up.

You then have a choice of the Start at, Finish at and EcoStart or SmartStart functions.

- Select the function you want.

Now enter the time you want.

If, while you are setting the time, you do not press any sensors for several seconds, the display will revert to the previous menu. You will then have to enter your settings again.

If you keep the relevant arrow sensor   pressed, the value shown will automatically increase or decrease.

Start at

With the **Start at** function, you set the exact time you want the programme to start at.

- Use the \vee/\wedge arrows to set the hour and confirm with **OK**.

The hours will be saved and the minute number block will be highlighted.

- Use the \vee/\wedge arrows to set the minutes and confirm with **OK**.

The display will change to show the programme menu.

- Close the door.

The left hand in-operation indicator light will start flashing on and off.

When the set time is reached, the programme selected will begin automatically.

Finish at

With the **Finish at** function, you set the latest time at which you wish the programme to end.

- Use the \vee/\wedge arrows to set the hour and confirm with **OK**.

The hours will be saved and the minute number block will be highlighted.

- Use the \vee/\wedge arrows to set the minutes and confirm with **OK**.

The display will revert to the programme menu and the estimated start time will appear.

- Close the door.

The left hand in-operation indicator light will start flashing on and off.

A message will appear in the display if the programme cannot be completed by the set finish time because it has too long a running time.

The selected programme will start automatically when the estimated start time is reached.

Programme options

EcoStart

The EcoStart function allows you to take advantage of time variable economy rates of electricity. Before you can use this option you must set up to three electricity tariff time zones (see "Settings, EcoStart").

You then set the latest time at which the programme selected should end.

The dishwasher will start automatically in the cheapest tariff zone within the time set.

- Use the \vee/\wedge arrows to set the hour and confirm with **OK**.

The hours will be saved and the minute number block will be highlighted.

- Use the \vee/\wedge arrows to set the minutes and confirm with **OK**.

The display will change to show the programme menu.

- Close the door.

The left hand in-operation indicator light will start flashing on and off.

The selected programme will start automatically during the most cost effective time zone. It will finish at the latest by the set finish time.

SmartStart

The SmartStart function is used for starting your dishwasher automatically at a time when your energy costs are most economical.

If the SmartStart option has been activated in the Settings menu, SmartStart will appear in the Delay start menu instead of EcoStart (see "Settings, Miele@home, SmartStart").

If your energy provider offers this service, they will send a signal to your dishwasher when energy costs are at their most economical.

This signal will start the dishwasher.

You can set a time, by which the programme has to have finished by. The dishwasher will then calculate the latest possible start time for the programme selected and will wait until this start time for the signal from the energy provider.

Set the time, by which the selected programme has to be finished by.

- Use the \vee/\wedge arrows to set the hour and confirm with **OK**.

The hours will be saved and the minute number block will be highlighted.

- Use the \vee/\wedge arrows to set the minutes and confirm with **OK**.

Waiting for SmartStart will appear in the display.

- Close the door.

The left hand in-operation indicator light will start flashing on and off.

The selected programme will start automatically, as soon as the energy provider has sent the signal, or the latest calculated start time has been reached.

Changing or deleting set times

You can change the set times or the programme before the start time in the display is reached.

- Open the door.
- Press the \oplus button.
- Select the function that you want to change or delete the time for.

After confirming the **Change** option you can change the set time.

After confirming the **Delete** option the set time will be deleted and the \oplus indicator light will go out.

You can now select and start a programme.

Programme options

Heat exchanger

This dishwasher is equipped with a heat exchanger, in which fresh water for the programme is pre-heated, in order to save energy. The heat exchanger is re-filled with fresh water towards the end of each phase that uses fresh water and is held there ready for the next part of the programme.

If you do not wish to use this function it can be switched off (see "Settings, Heat exchanger").

If water in the heat exchanger is not used for several weeks, it will be automatically drained and pumped away for hygiene reasons. This process takes a few minutes and will also be carried out if the dishwasher is switched off or the door is open.

The display will remain dark. The message *Empty accumulat.* will appear in the display when the ⓘ button is pressed. No other functions are available during this process.

Automatic drainage cannot be interrupted.

The heat exchanger can be manually drained for transporting the appliance, e.g. before moving house (see "Settings, Heat exchanger").

The heat exchanger should only be used in conjunction with a cold-fill dishwasher.

This function should be switched off if your dishwasher is connected to a hot water supply.

DetergentAgent

For optimum cleaning results, the dishwasher automatically adjusts the programme sequence to the type of detergent being used. Depending on the programme, this can mean that the running time and energy consumption vary slightly.

If you only ever use combination products containing salt and rinse aid in your dishwasher, you can switch the reminders off if you wish (see "Settings menu, Refill reminders"). The Detergent-Agent function will not be affected by this.

Please make sure that if you start using dishwasher salt and rinse aid again, you switch the reminders back on.

Programme chart

Programme	Programme sequence				
	Pre-wash	Main wash °C	Interim rinse	Final rinse °C	Drying
ECO ¹⁾		54	X	44	X
Automatic	Variable programme sequence, sensor-controlled adjustment according to the amount of crockery and level of food deposits				
	If required	45-65	If required	57-70	X
Intensive 75 °C	2X	75	X	58	X
QuickPower Wash		65	X	65	X
Gentle 55 °C	X	45	X	58	X
Normal 55 °C	X	55	X	58	X
ExtraQuiet		46	X	64	X
Hygiene		69	2X	70	X
SolarSave	2X	X	X	X	X
Tall items 65 °C	X	65	X	58	X
Pasta/Paella	X	75	X	58	X
Glasses warm		40	2X	54	
Maintenance programme		75	2X	70	X

¹⁾ This programme is the most efficient in terms of its combined energy and water consumption for cleaning normally soiled crockery.

Programme chart

Consumption ²⁾			Duration ²⁾	
Energy		Water		
Cold water 15 °C kWh	Hot water 55 °C kWh	Litres	Cold water 15 °C h:min	Hot water 55 °C h:min
0.67	0.49	9.9	3:42	3:20
0.75 ³⁾ -1.05 ⁴⁾	0.50 ³⁾ -0.65 ⁴⁾	6.5 ³⁾ -15.0 ⁴⁾	2:05-3:21	1:48-2:58
1.30	0.90	14.5	3:28	3:05
1.30	0.80	11.5	0:58	0:58
0.90	0.45	13.5	2:33	2:07
1.00	0.55	13.5	2:41	2:19
1.05	0.75	9.5	4:34	4:25
1.50	1.15	13.0	2:41	2:27
	0.06	27.0		2:20
1.10	0.55	14.0	2:05	1:53
1.30	0.95	14.0	2:56	2:35
0.80	0.40	13.5	1:17	1:03
2.10	1.30	22.0	2:36	2:11

²⁾ Values quoted are in accordance with EN 50242. In practice there may be variations to these figures due to variable conditions and data recorded by the sensors. Durations shown will reflect your household conditions.
Selecting programme options will also affect consumption levels and programme durations (see "Programme options").

³⁾ Part load with light soiling





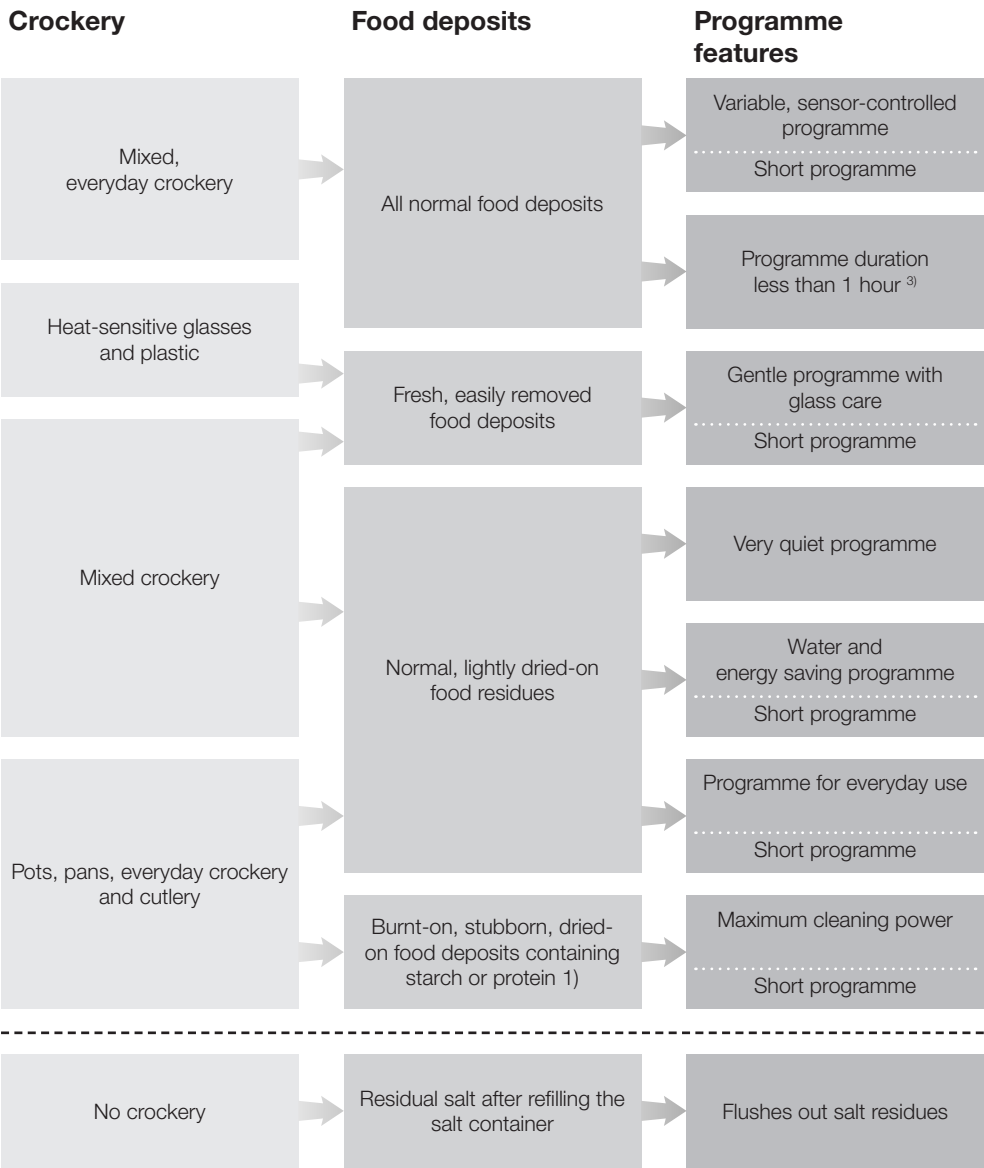









⁴⁾ Full load with heavy soiling

Programme chart



¹⁾ Food such as potatoes, pasta, rice or stews can leave starchy deposits. Deposits containing protein can be left by food such as meat, fish or eggs and bakes.

Programme chart

Programme	Detergent	
	Compartment I ²⁾	Compartment II ²⁾
  Automatic +short	-	25 ml or 1 tab
 QuickPowerWash	-	1 tab ³⁾
  Gentle  +short	-	20 ml or 1 tab
 ExtraQuiet	-	25 ml or 1 tab
  ECO +short	-	25 ml or 1 tab
  Normal 55 °C +short	-	25 ml or 1 tab
  Intensive 75 °C +short	10 ml	25 ml or 1 tab
<hr/>		
 QuickPowerWash +short	-	-

²⁾ see "Detergent"

³⁾ best cleaning results are only achieved using Miele's quick dissolving UltraTab Multi

Programme chart

Further programmes

Hygiene

Special programme for items which need to be hygienically clean, e.g. baby bottles and chopping boards.

SolarSave

This programme does not heat the water. To use it the water intake temperature must be at least 45 °C / 115 °F (see "Plumbing, Connection to the water supply"). This programme is suitable for mixed loads of crockery and glassware with normal, slightly dried on food residues.

Pasta/Paella

Programme with long soak phase incorporated for mixed loads of crockery, pots and pans and robust porcelain. This programme is particularly suitable for removing soiling containing starch left by pasta, rice and potatoes.

Tall items 65 °C

Programme for very large heat-resistant items, (e.g. very deep pans). In this programme the upper basket is removed to make space for large items in the lower basket. This programme has a medium action to remove normal, slightly dried on residues.

Glasses warm

This programme does not use rinse aid and omits the drying phase. It is particularly suitable for cleaning beer glasses where a good head of froth is needed.

Maintenance programme

The wash cabinet is largely self-cleaning. However, if residues or soiling build up in the cabinet, they can be removed by running the "Maintenance programme" without a load. This programme is designed for cleaning the wash cabinet using care products such as Miele's dishwasher cleaner or conditioner (see "Optional accessories, Dishwasher care products"). Please follow usage instructions on the packaging.

Check your dishwasher regularly (approx. every 4 - 6 months). This way faults and problems can be avoided.



The external surfaces of the dishwasher are susceptible to scratching.

Contact with unsuitable cleaning agents can alter or discolour the external surfaces.

Cleaning the wash cabinet

The wash cabinet is largely self-cleaning, provided that the correct amount of detergent is always used.

If, however, there are limescale or grease deposits in the cabinet, these can be removed with a special cleaning agent (available from Miele). Follow the instructions on the packaging.

If you mainly use low temperature programmes (below 50 °C), there is a risk of bacteria and unpleasant odours building up in the wash cabinet. To prevent this happening the dishwasher will automatically increase the temperature in the final rinse of the selected programme after several programmes using low temperatures have been run.

- Clean the filters in the wash cabinet regularly.

Cleaning the door and the door seal

Mould could build up on the door seal and the sides of the dishwasher door as these surfaces are outside the wash cabinet and so not accessed and cleaned by the spray arm jets.

- Wipe the door seal regularly with a damp cloth to remove food deposits.
- Wipe off any food or drink residues which may have dripped onto the sides of dishwasher door before closing it.

Cleaning the control panel

- The control panel should **only** be wiped with a damp cloth.

Cleaning the reflector panel

The reflector panel for the In-operation indicator light is situated in the coverplate underneath the worktop.

- The reflector panel should only be wiped with a damp cloth or a suitable cleaning agent designed for use on plastic.

Cleaning and care

Cleaning the door front

 Soiling that is left too long might become impossible to remove and could cause the external surfaces to alter or discolour.

Remove any soiling immediately.

- Clean the front with a clean sponge and a solution of hot water and washing-up liquid. After cleaning dry with a soft cloth.

A clean, damp microfibre cloth without cleaning agent can also be used.

To avoid damaging the external surfaces, do not use:

- cleaning agents containing soda, ammonia, acids or chlorides,
- cleaning agents containing descaling agents,
- abrasive cleaning agents, e.g. powder cleaners and cream cleaners,
- solvent-based cleaning agents,
- stainless steel cleaning agents,
- dishwasher cleaner,
- oven sprays,
- glass cleaning agents,
- hard, abrasive brushes or sponges, e.g. pot scourers, brushes or sponges which have been previously used with abrasive cleaning agents,
- melamine eraser blocks,
- sharp metal scrapers,
- wire wool,
- steam cleaning appliances.

Checking the filters in the wash cabinet

The filter combination in the base of the wash cabinet retains coarse soil from the suds solution, preventing it accessing the circulation system and re-entering the cabinet through the spray arms.

 This dishwasher must not be used without all the filters in place.

Collection of coarse soil may cause the filters to clog. The level of soiling and time it takes before the filters need cleaning will vary depending on use.

The message **Check filters** will appear in the display after every 50 programme cycles (factory default setting).

You can set the interval for this message to appear to between 30 and 60 programme cycles (see "Settings menu, Check filters").

- Check the filter combination.
- Clean it, if necessary.
- Then confirm the message with **OK**.

The message goes out.

The display will change to show the programme selection menu.

Cleaning the filters

- Switch the dishwasher off.

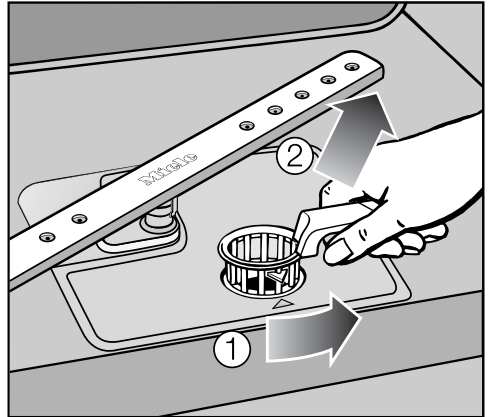

- Turn the handle anti-clockwise to release the filter combination ①.
- Lift the filter combination out of the dishwasher ②. Remove any coarse particles and rinse the filter well under running water. Use a nylon brush if necessary.

 Make sure that when cleaning the filters, no coarse soil falls into the circulation system, causing a blockage.

Cleaning and care

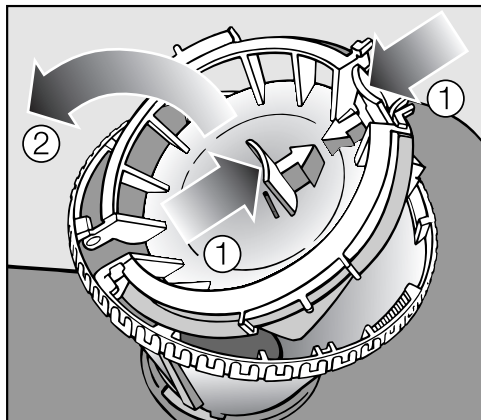

To clean the inside of the filter, the flap must be opened:

- Press catches ① together in the direction of the arrows as shown, and open the filter ②.
- Rinse all the filters under running water.
- Then close the flap so that the catch engages.

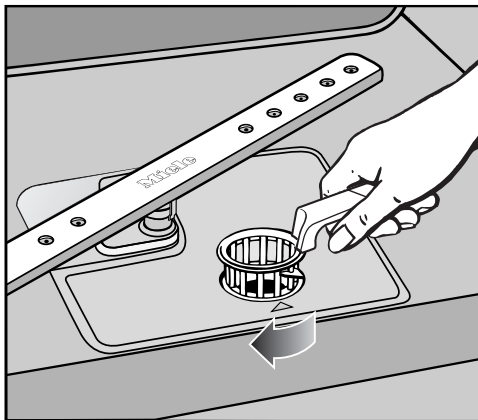

- Replace the filter combination so that it lies flat in the base of the wash cabinet.
- Then turn the handle clockwise to lock the filter combination in place.

⚠ Take care when you are fitting the filter combination that it is secured in position correctly. Otherwise coarse soil could get into the circulation system and cause a blockage.

Cleaning the spray arms

Particles of food can get stuck in the spray arm jets and bearings. The spray arms should therefore be inspected and cleaned regularly (approx. every 4 - 6 months).

- Switch the dishwasher off.

Remove the spray arms as follows:

- Take out the cutlery tray (if your dishwasher is fitted with one).
- Push the **top** spray arm upwards to engage the inner ratchet. Then unscrew the spray arm.

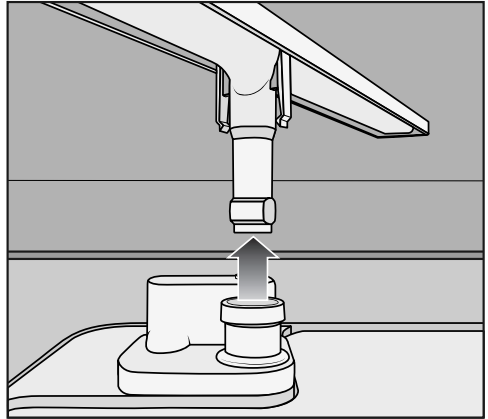

- Pull the **lower** spray arm firmly upwards to remove it.

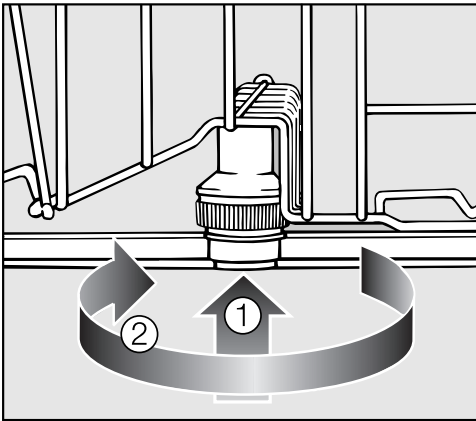

- Push the **middle** spray arm upwards ① to engage the ratchet. Then unscrew the spray arm ②.
- Remove the lower basket.

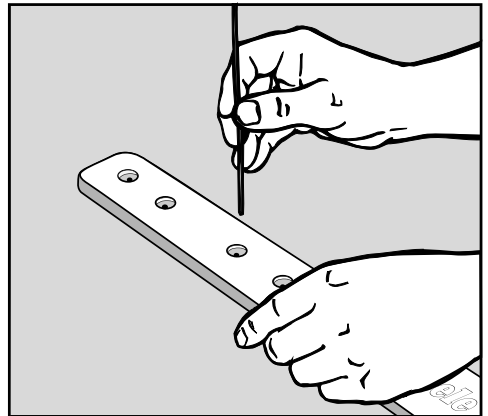

- Use a pointed object to push food particles into the spray arm jets.
- Rinse thoroughly under running water.
- Replace the spray arms and check that they rotate freely.

Problem solving guide

Most minor faults in the performance of the appliance, some of which may result from incorrect operation, can be put right without contacting the Service Department.

The following guide may help you to find the reason for a fault, and to correct it. You should, however, note the following:



 Unauthorised or incorrect repairs could cause personal injury or damage to the appliance.

Repair work to electrical appliances must only be carried out by a suitably qualified and trained person in strict accordance with current local and national safety regulations. The manufacturer cannot be held liable for unauthorised work.

Technical problems

Problem	Cause and remedy
The dishwasher will not start.	The door is not properly closed. ■ Raise the door upwards until the catch engages.
	The appliance is not plugged in. ■ Insert the plug and switch on at the socket.
	The mains fuse has tripped. ■ Reset the trip switch in the mains fuse box or replace the fuse in the plug (minimum fuse rating - see data plate).
	The dishwasher is not switched on. ■ Switch the dishwasher on with the ① button.
The dishwasher stops during a programme.	The mains fuse has tripped. ■ Reset the trip switch in the mains fuse box or replace the fuse in the plug (minimum fuse rating - see data plate). ■ If the mains fuse trips again, call the Miele Service Department.
After the programme has started, the In-operation indicator light is not visible.	The reflector panel was not correctly fitted. ■ Re-fit the reflector panel correctly (see Installation sheet).

Problem solving guide

Problem	Cause and remedy
<p>All in-operation indicators are flashing quickly. The warning buzzer is sounding. One of the following faults is shown in the display:</p>	<p>Before rectifying the problem:</p> <ul style="list-style-type: none"> ■ Switch the dishwasher off using the ① sensor.
<p> Technical fault FXX</p>	<p>There may be a technical fault.</p> <p>After a few seconds:</p> <ul style="list-style-type: none"> ■ Switch the dishwasher back on. ■ Select the programme you want. ■ Close the door. <p>If the fault message appears again, there is a technical fault.</p> <ul style="list-style-type: none"> ■ Call the Miele Service Department.
<p> Waterproof fault</p>	<p>The Waterproof system has reacted.</p> <ul style="list-style-type: none"> ■ Close the stopcock. ■ Call the Miele Service Department.
<p> Technical fault F78</p>	<p>A fault has occurred in the circulation pump.</p> <ul style="list-style-type: none"> ■ Switch the dishwasher off for at least 30 seconds with the ① sensor. ■ Switch the dishwasher back on. ■ Select the programme you want. ■ Close the door. <p>If the fault message appears again, there is a technical fault.</p> <ul style="list-style-type: none"> ■ Call the Miele Service Department.

Problem solving guide

Problem	Cause and remedy
All in-operation indicators are flashing quickly. The warning buzzer is sounding. One of the following faults is shown in the display:	Before rectifying the problem: <ul style="list-style-type: none">■ Switch the dishwasher off with the ① button.
Fault auto. door closing	The door might be obstructed by an item inside the appliance. <ul style="list-style-type: none">■ If this is the case, remove the item causing an obstruction and switch the dishwasher on again.■ If the same message appears again, call the Service Department.
Fault auto. door opening	There may be a technical fault. <ul style="list-style-type: none">■ Open the door manually (see "Opening the door, Emergency door opener").■ If the same message appears again, call the Service Department.

Water inlet fault

Problem	Cause and remedy
<p>All in-operation indicators are flashing quickly. The warning buzzer is sounding. One of the following faults is shown in the display:</p>	
<p>🔌 Water inlet fault. Please open the stopcock</p>	<p>The stopcock is closed.</p> <ul style="list-style-type: none"> ■ Open the stopcock fully.
<p>🔌 Water inlet fault</p>	<p>Before rectifying the problem:</p> <ul style="list-style-type: none"> ■ Switch the dishwasher off using the ① sensor. <p>The water intake is restricted.</p> <ul style="list-style-type: none"> ■ Open the stopcock fully and start the programme again. ■ Clean the water inlet filter (see "Maintenance"). ■ The water pressure at the intake is lower than 50 kPa (0.5 bar). Seek professional advice.
<p>The following message appears in the display during the SolarSave programme:</p> <p>📌 Water in. temp. too low</p>	<p>The intake water has not reached the required temperature of 45 °C (see "Plumbing, Connection to the water supply").</p> <ul style="list-style-type: none"> ■ Start the programme again. ■ If the fault message appears again, select a different programme.

Problem solving guide

Water drainage fault

Problem	Cause and remedy
All in-operation indicators are flashing quickly. The warning buzzer is sounding. The following fault is shown in the display:  Drain fault	Before rectifying the problem: ■ Switch the dishwasher off with the ① button.
	The water outlet is restricted. There might be water in the wash cabinet. ■ Clean the filter combination (see "Cleaning and care, Cleaning the filters"). ■ Clean the drain pump (see "Maintenance"). ■ Clean the non-return valve (see "Maintenance"). ■ Remove any kink or loop in the drain hose.

General problems

Problem	Cause and remedy
The door will not open when knocked.	<p>The Knock2open function has been permanently disabled.</p> <ul style="list-style-type: none"> ■ Switch the door opening mechanism on again (see "Settings, Knock2open"). <p>If the door will still not open or if there is a power cut the door can still be opened with the door opening device supplied (see "Before using for the first time, Emergency door opener").</p>
The interior lighting does not come on when the door is opened.	<p>The lighting has been switched off permanently.</p> <ul style="list-style-type: none"> ■ Switch the lighting back on again (see "Settings menu, BrilliantLight").
The following fault is shown in the display:  Salt reservoir lid During the programme the warning buzzer is also sounding and the In operation indicator light is flashing.	<p>The salt reservoir lid has not been closed properly.</p> <ul style="list-style-type: none"> ■ Close the salt reservoir lid.
	<p>If the salt reservoir lid has opened during a programme:</p> <ul style="list-style-type: none"> ■ Switch the dishwasher off and back on again with the ⏻ button. ■ Close the salt reservoir lid. ■ Start the programme again.
Detergent residue is left in the dispenser at the end of a programme.	<p>The dispenser was still damp when detergent was added.</p> <ul style="list-style-type: none"> ■ Make sure the dispenser is dry before adding detergent.
The detergent dispenser lid cannot be closed properly.	<p>Clogged detergent residue is blocking the catch.</p> <ul style="list-style-type: none"> ■ Clean the detergent from the catch.
At the end of a programme there is a film of moisture on the inside of the door and the interior walls.	<p>This is caused by the drying system and does not indicate a fault. The moisture will dissipate after a while.</p>

Problem solving guide

Problem	Cause and remedy
Water remains in the wash cabinet at the end of a programme.	Before rectifying the problem: ■ Switch the dishwasher off using the ① sensor.
	The filter combination in the wash cabinet is clogged. ■ Clean the filter combination (see "Cleaning and care, Cleaning the filters").
	The drain pump or non-return valve may be blocked. ■ Clean the drain pump or the non-return valve (see "Maintenance").
	The drain hose is kinked. ■ Remove any kink from the drain hose.

Noises

Problem	Cause and remedy
Knocking noise in the wash cabinet.	<p>A spray arm is knocking against an item in a basket.</p> <ul style="list-style-type: none">■ Interrupt the programme, and rearrange the items which are obstructing the spray arm.
Rattling noise in the wash cabinet.	<p>Items of crockery are insecure in the wash cabinet.</p> <ul style="list-style-type: none">■ Interrupt the programme, and rearrange the items of crockery.
	<p>A foreign object (e.g. a cherry stone) has become lodged in the drain pump.</p> <ul style="list-style-type: none">■ Remove the foreign object from the drain pump (see "Maintenance, Cleaning the drain pump and non-return valve").
Knocking noise in the water pipes.	<p>This may be caused by the on-site installation or the cross-section of the piping.</p> <ul style="list-style-type: none">■ This has no influence on dishwasher function. If in doubt, contact a suitably qualified plumber.

Problem solving guide

Unsatisfactory washing result

Problem	Cause and remedy
The dishes are not clean.	The dishes were not loaded correctly. ■ See notes in "Loading the dishwasher".
	The programme was not powerful enough. ■ Select a more powerful programme (see "Programme chart").
	There is some stubborn soiling although most of the crockery is only lightly soiled (e.g. with tea stains). ■ Use the Automatic programme option (see "Settings menu, Automatic").
	Not enough detergent was dispensed. ■ Use more detergent, or change your detergent.
	Items are blocking the path of the spray arms. ■ Rearrange the items so that the spray arms can rotate freely.
	The filter combination in the base of the wash cabinet is not clean or is not correctly fitted. This may cause the spray arm jets to get blocked. ■ Clean and/or fit the filter combination correctly. ■ Clean the spray arm jets, if necessary (see "Cleaning and care, Cleaning the spray arms").
	The non-return valve is open and blocked. Dirty water has flowed back into the wash cabinet. ■ Clean the drain pump and the non-return valve (see "Maintenance, Cleaning the drain pump and non-return valve").
Smearing appears on glassware and cutlery. There is a bluish sheen on the surface of glassware; film can be wiped off.	The rinse aid dosage is set too high. ■ Reduce the dosage (see "Settings menu, Rinse aid").

Problem solving guide

Problem	Cause and remedy
Crockery is not dry or cutlery and glasses are flecked.	The rinse aid dosage is set too low or the rinse aid reservoir is empty. ■ Replenish the reservoir, increase the dosage or change the brand of rinse aid (see "Before using for the first time, Rinse aid").
	Crockery was taken out of the cabinet too soon. ■ Leave it in for longer (see "Operation").
	Combination products have been used which have impaired drying performance. ■ Change your detergent, or replenish the rinse aid (see "Before using for the first time, Rinse aid").
Glassware has a brown or blue tinge, and film cannot be wiped off.	This may be caused by the detergent. ■ Change your detergent.
Glassware is dull and discoloured; film cannot be wiped off.	The glassware is not dishwasher-proof. The surfaces are affected. ■ There is no remedy. Purchase glassware which is dishwasher-proof.
Tea or lipstick stains have not been completely removed.	The wash temperature of the selected programme was too low. ■ Select a programme with a higher wash temperature.
	The bleaching effect of the detergent used is too low. ■ Change your detergent.
Plastic items are discoloured.	Natural dyes e.g. from carrots, tomatoes or ketchup may be the cause. The amount of detergent used or its bleaching effect was not sufficient to deal with natural dyes. ■ Use more detergent (see "Operation, Detergent"). Discolouration is irreversible.

Problem solving guide

Problem	Cause and remedy
White residue is visible on crockery and cutlery, clouding occurs on glassware; film can be wiped off.	The rinse aid dosage is set too low. ■ Increase the dosage (see "Settings menu, Rinse aid").
	There is no salt in the salt reservoir. ■ Fill the salt reservoir (see "Before using for the first time, Dishwasher salt").
	An unsuitable combination product has been used. ■ Change your detergent. Use a standard liquid, tablet or powder detergent.
	The water softener is programmed to too low a water hardness level. ■ Programme the water softener to a higher water hardness level (see "Settings menu, Water hardness").
There are rust stains on cutlery.	The affected items are not corrosion resistant. ■ There is no remedy. Purchase cutlery which is dishwasher-proof.
	A programme was not run after dishwasher salt was added. Traces of salt have got into the wash cycle. ■ Always run the <i>QuickPowerWash</i> programme with the <i>Short</i> programme option selected and without any crockery in the dishwasher after adding dishwasher salt.

Cleaning the water inlet filter

A filter is incorporated in the screw connection of the valve on the water inlet hose. The filter must be cleaned when dirty, otherwise insufficient water flows into the wash cabinet.

⚠ The plastic housing of the water connection contains an electrical component.
The housing must not be dipped in water.

Recommendation

If the mains water contains a large number of insoluble substances, we recommend fitting a large-area filter in the connection between the stopcock and the water inlet hose threaded union. This filter is available from Miele.

Cleaning the filter:

- Disconnect the dishwasher from the mains supply.
Switch off at the mains socket and withdraw the plug.
- Close the stopcock.
- Unscrew the inlet hose.

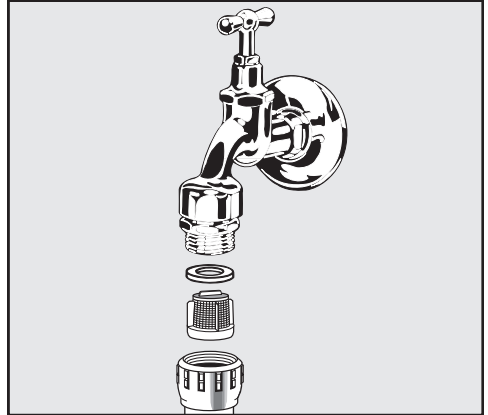

- Carefully remove the seal.
 - Withdraw the filter using pointed pliers and rinse clean under running water.
 - Replace the filter and seal, making sure they are sitting correctly.
 - Reconnect the inlet hose to the stopcock, making sure it goes on correctly and is not cross-threaded.
 - Open the stopcock.
- If water leaks out, the inlet hose may not be connected securely or it may have been screwed on at an angle.
- Unscrew and reconnect the water inlet valve correctly.

Maintenance

Cleaning the drain pump and non-return valve

If the water has not been pumped away at the end of a programme the drain pump or the non-return valve might be blocked. They are, however, easy to clean.

- Disconnect the dishwasher from the mains supply. Switch off at the mains socket and withdraw the plug.
- Take the filter combination out of the wash cabinet (see "Cleaning and care", "Cleaning the filters").
- Scoop the water out of the cabinet using a suitable container or utensil.

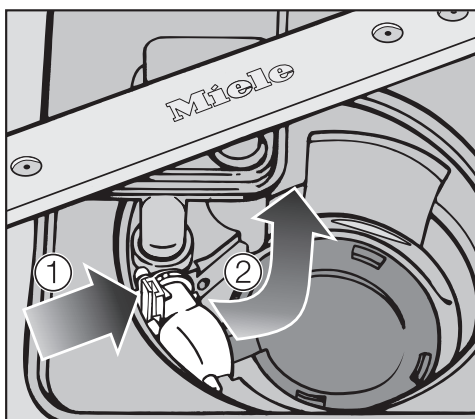

- Press the catch for the non-return valve inwards ①.
- Tilt the non-return valve inwards until it is released ②.
- Rinse it thoroughly under running water and remove any soiling from the non-return valve.

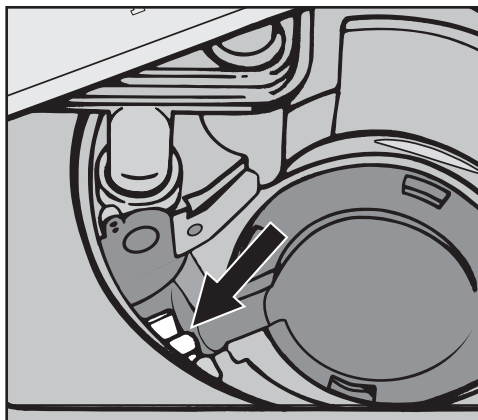

The drain pump is situated under the non-return valve (see arrow).

- Remove all foreign objects from the drain pump carefully (watch out for glass splinters which are particularly difficult to detect). Turn the drain pump impeller by hand to check that there are no more obstructions. You will feel a little resistance when you turn the impeller.
- Carefully replace the non-return valve.

⚠ Ensure that the catch engages correctly.

⚠ Be very careful not to damage sensitive components when cleaning the drain pump and the non-return valve.

Repairs

In the event of any faults which you cannot remedy yourself, please contact:

- your Miele Dealer, or
- the Miele Service Department

Contact details for Miele are given at the end of this booklet. N.B. A call-out fee will be charged for service visits where the problem could have been resolved as described in these instructions.

When contacting the Service Department or your Dealer, please quote the model and serial number of your dishwasher, both of which are shown on the data plate on the right hand side of the door.

Guarantee

In the U.K, the appliance is guaranteed for 2 years from the date of purchase. However, you must activate your cover by calling 0845 365 6640 or registering online at www.miele.co.uk.

Guarantee: Other countries

For information on the appliance guarantee specific to your country please contact Miele. See end of this booklet for contact details.

Note for test institutes

All information required regarding comparison testing and measuring noise levels is given in the "**Comparison tests**".

The latest version of this leaflet can be ordered by email from:

- testinfo@miele.de

Please quote your postal address, as well as the model and serial number of your dishwasher (see data plate).

Optional accessories

Dishwasher detergent and rinse aid as well as cleaning and care products are available as optional accessories. All the products are designed for use with Miele dishwashers.

These and many other useful products can be ordered from Miele or via the Miele Webshop (see end of this booklet for contact details).

Dishwasher detergent, rinse aid and salt

When you decided to buy a Miele dishwasher you chose excellent quality and performance. However, ensuring that your dishwasher always delivers the best possible results will also depend on your choice of dishwasher detergent, rinse aid and salt, as cleaning results can vary depending on the brand used.

With Miele CareCollection products, you can be sure of optimum results as these products have been specially designed for Miele dishwashers.

Detergent tabs

- sparkling results even with stubborn food deposits
- combination product with other components such as rinse aid, salt and glass protection additives
- phosphate free - helps protect the environment
- water-soluble wrapping - no need to unwrap

Powder detergent

- with active oxygen for thorough cleaning
- with enzymes which are effective even in low temperature programmes
- with glass protection against corrosion

Rinse aid

- for sparkling glasses
- helps crockery to dry
- with glass protection against corrosion
- specially designed cap for precise, easy dispensing

Dishwasher salt

- prevents limescale on crockery and in the appliance
- extra coarse-grained

Dishwasher care products

Miele cleaning and care products provide optimum care for your dishwasher.

Dishwasher cleaner

- cleans the dishwasher effectively and thoroughly
- removes grease, bacteria and unpleasant odours
- ensures excellent dishwashing results

Descaling agent

- removes heavy limescale deposits
- mild and gentle with natural citric acid

Conditioner

- removes odours, limescale and light deposits
- maintains the elasticity and leak tightness of the seals

Freshener

- neutralises unpleasant odours
- fresh, pleasant lime and green tea scent
- easy to attach to the dishwasher basket
- very economical, lasts for 60 wash cycles

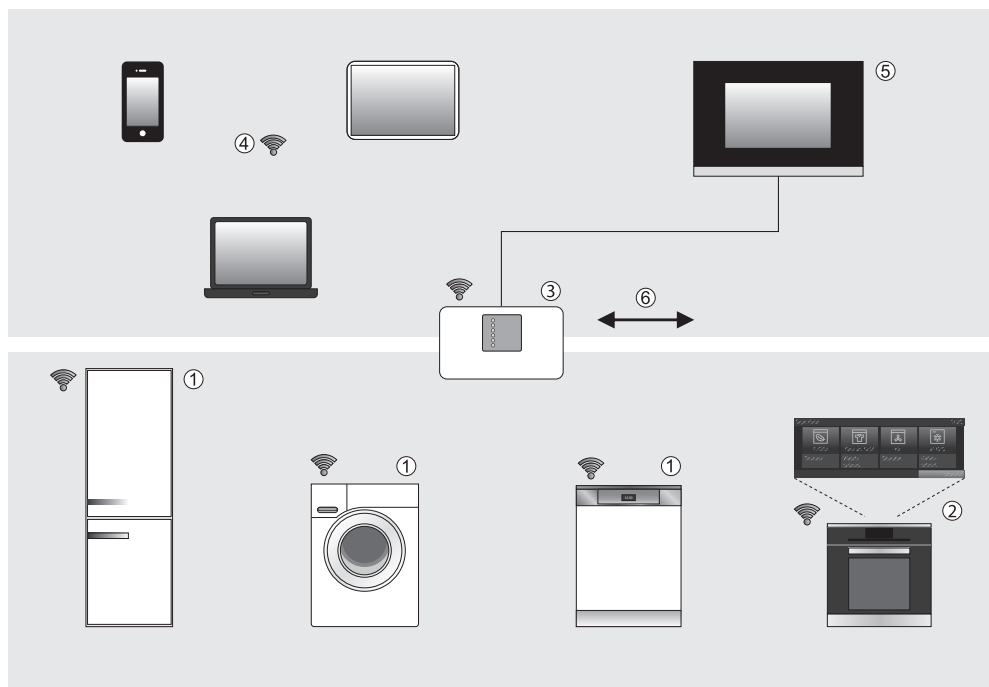

- ① Miele@home communication enabled appliance
- ② Miele@home communication enabled Master appliance with SuperVision functionality
- ③ Wi-Fi Router
- ④ Mobile device (Smartphone, Tablet PC, Notebook)
- ⑤ Connection to a Home automation system
- ⑥ Internet connection

Your household appliance ①/ ② is network enabled.

Your household appliance needs a Wi-Fi module or a Wi-Fi stick (integrated in the appliance, supplied separately or available to order depending on appliance) in order to be connected to your network.

Your household appliance can be connected to the Miele@home system with the assistance of a Wi-Fi router ③ and the Miele@mobile App.

The Miele@home system enables network enabled household appliances to send information to a mobile device ④ or to a master appliance ②, such as an oven with SuperVision functionality, about their operational status, as well as information about the progress of the programme.

Displaying information and controlling appliances

- Mobile devices ④ with Miele@mobile App

A Smartphone, Tablet PC or Notebook can be used to display status information about signed on appliances and carry out certain functions. Further ways of using the Miele@mobile App will vary depending on the household appliance.

- SuperVision master appliance ②
The status of other signed on appliances can be shown in the display of some network enabled appliances.

Wi-Fi

Tip: Make sure that you have sufficient signal strength for your Wi-Fi network where the appliance is installed.

In order to connect an appliance with an integrated Wi-Fi module to your Wi-Fi network you must first activate the network function (see "Settings).

In order to connect an appliance with an external Wi-Fi module or a Wi-Fi stick to your Wi-Fi network you must first install the Wi-Fi module or the Wi-Fi stick (see fitting and installation instructions for your Wi-Fi module or Wi-Fi stick).

Further information

These accessories are supplied with their own installation and operating instructions.

Further information regarding Miele@home is available on the internet and in the instruction manuals of the various Miele@home components. Please note that the Miele@home and SuperVision system is currently only available in selected countries.

Miele@mobile App

The Miele@mobile App is available to download free of charge from the Apple App Store® or from the Google Play Store™.



Electrical connection

The appliance is supplied with a mains cable with moulded plug ready for connection to a switched socket.

 The electrical socket must be easily accessible after the dishwasher has been installed. Do not connect the dishwasher to the mains electricity supply by an extension lead. Extension leads do not guarantee the required safety of the appliance (e.g. danger of overheating).

If the connection cable is damaged, it must be replaced with a Miele cable of the same type (available from Miele) by a Miele approved service technician or suitably qualified person only.

Do not connect the appliance to an inverter such as those used with an autonomous energy source e.g. **solar power**. When switched on, peak loads in the system can cause the safety switch-off mechanism to be triggered. This can damage the electronic unit. The appliance must not be used with so-called **energy-saving devices** either. These reduce the amount of energy supplied to the appliance, causing it to overheat.

 Before connecting the appliance, check that the connection data on the data plate (voltage, frequency and fuse rating) matches the mains electricity supply. If in any doubt, consult a qualified electrician.

The data plate is located on the right-hand side of the door.

 The electrical installation must be in compliance with current local and national safety regulations. In the U.K. it must comply with BS 7671.

The Miele waterproof anti-leak system

Provided your dishwasher has been installed correctly, the Miele WaterProof System will protect you from water damage throughout its lifetime.

Connection to the water supply



Water in the dishwasher must not be used as drinking water.

- The dishwasher may be connected to a cold or hot water supply, max. 60 °C.

We would only recommend connection to a hot water supply if it is economical, e.g. a solar powered supply. When connected to a hot water supply all programme stages which would otherwise be carried out with cold water will be carried out with hot water.

- The SolarSave programme (if available) requires a hot water supply of between 45 °C (minimum) and 60 °C (maximum).

The higher the water intake temperature, the better the cleaning and drying results.

Plumbing

- The inlet hose is approx. 1.5 m long. A 1.5 m long flexible metal extension hose (pressure tested to 14000 kPa/140 bar) is available as an optional accessory, if required.
- A stopcock with a 3/4" male thread must be provided on site.
- This appliance is constructed to comply with IEC/EN/DIN 61770 // VDE 0700 Section 600, and may be connected to a suitable supply without an extra non-return valve if national regulations permit.
- The water pressure (flow pressure at the take-off point) must be between 50 and 1000 kPa (0.5 and 10 bar). If the water pressure is lower than this, the fault message *Water intake* will appear in the display (see "Problem solving guide"). If the water pressure is too high, a pressure reducer valve must be fitted.

After connecting the dishwasher to the water supply, check that all plumbing connections are watertight.

⚠ To avoid any damage to the appliance, the dishwasher must only be operated when it is connected to a fully vented plumbing system.

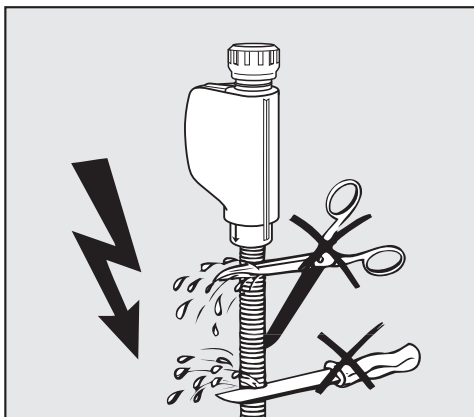

⚠ The inlet hose must not be shortened or damaged in any way as it contains electrical components (see illustration).

Drainage

- The appliance drainage system is fitted with a non-return valve, which prevents dirty water from flowing back into the dishwasher via the drain hose.
- The dishwasher is supplied with approx. 1.5 m of flexible drain hose with an internal diameter of 22 mm.
- The drain hose can be extended using a connection piece to attach a further length of hose. The drainage length must not be longer than 4 m, and the delivery head must not exceed 1 m.
- If the hose is to be directly fitted to the drainage outlet on site, use the hose clip supplied (see installation sheet).
- The hose can be directed to the left or the right of the appliance.
- The on-site connector for the drain hose can be adapted to different widths of hose. If the connector protrudes too far into the drain hose, it will need to be shortened. Otherwise the drain hose may become blocked.
- The drain hose must not be shortened.

 Make sure that there are no kinks in the hose, and that it is not squashed or stretched.

After connecting the dishwasher to the drainage system, check that all plumbing connections are watertight.

Venting the drainage system

If the on-site drain connection is situated lower than the guide path for the bottom basket rollers in the open door, the drainage system must be vented. Otherwise a siphoning effect during a programme can cause the appliance to empty itself of water.

- To vent it: Open the dishwasher door fully.

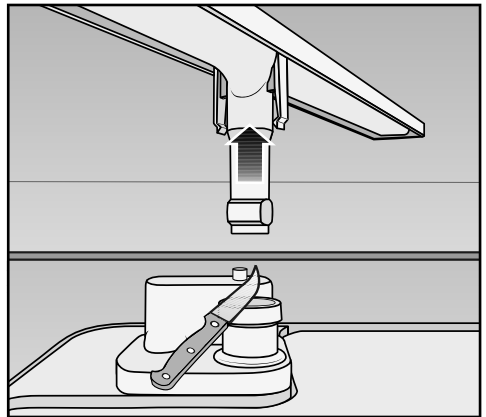

- Pull the lower spray arm firmly upwards to remove it.
- Cut off the top of the vent valve in the wash cabinet.

Technical data

Technical data

Dishwasher model	Standard	XXL
Height	80.5 cm (adjustable + 6.5 cm)	84.5 cm (adjustable + 6.5 cm)
Height of building-in recess	Min. 80.5 cm (+ 6.5 cm)	Min. 84.5 cm (+ 6.5 cm)
Width	59.8 cm	59.8 cm
Width of building-in recess	60 cm	60 cm
Depth	57 cm	57 cm
Weight	max. 53 kg	max. 59 kg
Voltage	See data plate	
Connected load	See data plate	
Fuse rating	See data plate	
Power consumption when switched off	0.3 W	0.3 W
Power consumption when not switched off	3.0 W	3.0 W
Networked standby	0.7 W	0.7 W
Test certificates awarded	See data plate	
Water pressure (flow rate)	50 - 1000 kPa (0.5 - 10 bar)	50 - 1000 kPa (0.5 - 10 bar)
Hot water connection	Up to max. 60 °C	Up to max. 60 °C
Delivery head	Max. 1 m	Max. 1 m
Drainage length	Max. 4 m	Max. 4 m
Mains cable	Approx. 1.7 m	Approx. 1.7 m
Capacity	13/14 place settings*	13/14 place settings*

* depending on model

Settings menu for changing standard settings

To open the Settings menu

- Switch the dishwasher on with the ① sensor if it is switched off.

The main menu will appear in the display.

If the memory function is activated, the programme menu for the programme last selected will be displayed instead (see "Settings, Memory"). If this is the case use the ↩ sensor to get to the main menu.

See "Guide to the appliance, Display" for more information about the display and controls.

- Select the Settings  option.

The display will change to show the Settings  menu.

- Select the option you want to change.

Touch the  sensor to call up more information about the programme currently selected.

Sub-menu options which have already been selected will have a tick ✓ beside them.

- To exit a sub-menu again use the ↩ sensor.

The display will revert to the menu above.

Settings menu

Language

The display can be set to appear in one of several different languages.

You can change the language in the display via the Language  sub-menu.

- Select the language you want and confirm this with OK.

Some languages also have a country option to select.

- If so, select the country you want and confirm your selection with OK.

The flag after the word Language  acts as a guide if a language which you do not understand has already been set.

If this the case, keep selecting the option which has a flag after it until you reach the Language  sub-menu.

Time

The current time of day must be set before you can use the Delay start option.

Setting the clock format

You can select either a 24 hour or 12 hour clock.

- Select the Clock format option.
- Select the setting you want and confirm with OK.

Setting the time of day

- Select the Set option.
- Set the hour with the \vee/\wedge arrow buttons and confirm with OK.
Then set the minutes and confirm with OK.

The time of day has now been saved.

Water hardness

Your dishwasher is fitted with a water softener which you need to programme to the water hardness level in your area.

- The dishwasher must be programmed to the correct water hardness for your area.
 - Your local water authority will be able to advise you of the water hardness level in your area.
 - Where the water hardness fluctuates e.g. between 1.8 and 2.7 mmol/l (10 - 15 °d - German scale) always programme the dishwasher to the higher value (2.7 mmol/l or 15 °d in this example).
- Select the water hardness you want, and confirm your selection with **OK**.

A tick ✓ will appear beside the water hardness which has been set.

°d	mmol/l	°f	Display
1	0.2	2	1
2	0.4	4	2
3	0.5	5	3
4	0.7	7	4
5	0.9	9	5
6	1.1	11	6
7	1.3	13	7
8	1.4	14	8
9	1.6	16	9
10	1.8	18	10

°d	mmol/l	°f	Display
11	2.0	20	11
12	2.2	22	12
13	2.3	23	13
14	2.5	25	14
15	2.7	27	15
16	2.9	29	16
17	3.1	31	17
18	3.2	32	18
19	3.4	34	19
20	3.6	36	20
21	3.8	38	21
22	4.0	40	22
23	4.1	41	23
24	4.3	43	24
25	4.5	45	25
26	4.7	47	26
27	4.9	49	27
28	5.0	50	28
29	5.2	52	29
30	5.4	54	30
31	5.6	56	31
32	5.8	58	32
33	5.9	59	33
34	6.1	61	34
35	6.3	63	35
36	6.5	65	36
37-45	6.6-8.0	66-80	37-45
46-60	8.2-10.7	82-107	46-60
61-70	10.9-12.5	109-125	61-70

Settings menu

Rinse aid

You can adjust the rinse aid dosage for best results.

The rinse aid dosage is set in stages from 0 to 6.

It is set to 3 at the factory.

If the function to adjust the Automatic programme has been activated, the amount of rinse aid dispensed in the Automatic programme can be higher than that set.

If spots appear on crockery and glassware:

- Increase the rinse aid dosage.

If clouding or smearing appears on crockery and glassware:

- Decrease the rinse aid dosage.

- Use the ∇/\wedge arrow buttons to set the level you want and confirm with OK.

Consumption (EcoFeedback)

You can programme the dishwasher so that the energy and water consumption of the currently selected programme appears in the display. The estimated consumption can be displayed before the programme starts and the actual consumption can be displayed after the programme has finished.

In this menu you can also call up the total energy and water used in all previous dishwasher programmes (see "Caring for the environment, EcoFeedback consumption indicator").

Consumption indicator

- Select the Display consumption option.
- Select the setting you want and confirm with OK.

Total consumption

You can display the values for Energy and Water.

- Select the Total consumption option.

You can also reset the values for the total consumption to 0.

- Select the Reset option.
- Select the Yes option.
- Confirm the message with OK.

The values are now reset to 0.

EcoStart

In order to run your dishwasher in the most economical way, you can use the EcoStart option to take advantage of your electricity supplier's time variable tariffs (see "Programme options, Delay start, EcoStart").

With this option selected, your dishwasher will start automatically at your electricity supplier's cheapest tariff times.

To use this option you must first set up to three electricity tariff time zones in which the dishwasher can start. You can allocate different priorities to these time zones. The time with the cheapest electricity tariff will be given Priority 1.

Contact your electricity supplier to find out the times of the cheapest electricity tariffs.

Once the electricity tariff times have been set, you can use the EcoStart option to set the latest finish time required for each programme.

The dishwasher will then start automatically in the cheapest electricity tariff time and the programme will end at the latest at the finish time set.

Setting the electricity tariff times

Before you can use the EcoStart option, you must set at least one electricity tariff time.

- Select an electricity tariff time from T1-T3 to set.

The start of the electricity tariff time selected will appear in the display and the hour number block will be highlighted.

- Use the ∇/\wedge arrow buttons to set the hours and minutes for the start time and confirm both with OK.

The end of the electricity tariff time selected will appear in the display and the hours number block will be highlighted.

- Use the ∇/\wedge arrow buttons to set the hours and minutes for the end time and confirm both with OK.

The electricity tariff time will be saved and its priority will appear in the display.

- Select the priority you want and confirm this with OK.

- Confirm the message with OK.

The electricity tariff time will be activated.

Settings menu

Changing the electricity tariff times

You can change the start, finish or priority of an electricity tariff time.

- Select an electricity tariff time from T1-T3 to change.
- Select the setting you want to change.
- Use the \vee/\wedge arrow buttons to change the setting and confirm with OK.

The change will be saved.

Deleting the electricity tariff times

- You can delete the settings for an electricity tariff time and in doing so deactivate the EcoStart option for this time zone.
- Select an electricity tariff time from T1-T3 to delete.
- Select Delete.
- Confirm the query Delete tariff T1? with Delete.

The settings for the electricity tariff time selected will be reset.

- Confirm the message with OK.

The electricity tariff time will be deleted.

Networking

Your dishwasher is equipped with an integrated WLAN module.

In order to connect your dishwasher to your WLAN network you must first activate the network function.

This will add the **Miele@home** option to the "Settings" menu.

Networking is deactivated ex-works.

Make sure that your WLAN network signal strength is strong enough at the installation site of your dishwasher.

- Select the setting you want and confirm with *OK*.

Miele@home

This option is only displayed if you have activated the network settings (see "Settings, Network").

There are a number of ways of connecting your dishwasher to your WLAN network:

Miele@mobile App

The Miele@mobile App can be used to connect to your network.

- Download the Miele@mobile App from one of the App stores.
- Follow the instructions in the App.

Settings menu

WPS Push Button

As an alternative to networking your dishwasher via the Miele@mobile App we recommend using WPS (Wireless Protected Setup). To do so you will need a WPS-compatible router.

- Select the WPS push button option.

Please wait... will appear in the display.

- Activate the "WPS" function on your router within two minutes.
- Once connection has been established, confirm with *OK*.

The dishwasher will then revert to the Miele@home menu.

If the connection fails, you have probably not connected WPS to your router quickly enough. Repeat the steps above.

SmartStart

The SmartStart function is used for starting your dishwasher automatically at a time when your energy costs are most economical.

Once SmartStart Permitted has been activated, the Delay start menu for the programme selected will no longer show the EcoStart option. Instead SmartStart will appear in the display. The dishwasher will then start within a timeframe set by you once it receives the signal from your energy provider.

If it has not received a signal from your energy provider by the latest start time set, the dishwasher will start automatically.

- Select the setting you want and confirm with *OK*.
- Confirm the message with *OK*.

Remote control

Once you have installed the Miele@mobile App on your tablet PC or your Smartphone, you will be able to operate your dishwasher remotely. Your dishwasher must be signed on to a WLAN network and the Remote control function must be activated.

- Select the setting you want and confirm with **OK**.

After activating the Remote control function, the MobileControl option will appear in the display.

In order to operate the dishwasher with the Miele@mobile App, please activate the MobileControl function.

- Touch the ↶ twice to return to the main menu.
- Select the MobileControl option.
- Confirm the message with **OK** and close the door.

The left hand in-operation indicator light will start flashing on and off.

The dishwasher can now be operated remotely using the Miele@mobile App.

If you now do not wish to operate the dishwasher remotely with the Miele@mobile App, you can cancel the MobileControl function.

- Open the door.
- Select **Cancel** and confirm with **Yes**.

Settings menu

System settings

You can use this option to sign your dishwasher onto an existing Miele@home network or create a Miele@home network with your dishwasher.

For instructions on how to do so please read your Miele@home instruction manual. This is available to download as a pdf from www.miele-at-home.de.

Module settings

We recommend connecting your dishwasher to your WLAN network with the help of the Miele@mobile App or via WPS.

If you would rather set up the connection to your router yourself, or you have a special network configuration, you can enter the relevant settings using the necessary technical knowledge.

Start module activity

If you wish to reset all entered settings and values for Miele@home, you can restore the factory default settings on your WLAN module. Any settings, which do not affect Miele@home will remain unchanged.

- Select Restart with default settings and confirm with **OK**.

Please wait... will appear in the display.

The message Restart default settings will appear in the display after a few minutes.

- Confirm the message with **OK**.

The WLAN module factory default settings have been restored.

If the factory default settings were not restored to your WLAN module, repeat the instructions above.

Change main menu

You can change the order of the programmes in the programme selection menu and also enter your favourite programmes into the first two programme places.

- Select the programmes you want to place in the first and second position of the programme selection menu.
- Confirm each position with OK.

The programmes you have selected will then appear together in the display.

- If you are happy with the order they are shown in confirm with OK.
- To change the order they are shown in select Change main menu.

Enter the settings again.

Save extras

Additional programme options can be added to some programmes, e.g. Short (see "Programme options, Extras").

You can use the Save extras option to save settings you have chosen for a particular programme so that they are automatically selected when you run the programme in the future.

The dishwasher is delivered with this function deactivated.

- Select the setting you want and confirm with OK.

Temperature

The temperature can be displayed in °C/Celsius or °F/Fahrenheit.

The factory default setting is °C.

- Select the option you want and confirm with OK.

Brightness

There are seven different display brightness settings.

- Select the brightness you want and confirm this with OK.

Settings menu

Volume

A sequence of audible tones will sound at the end of the programme or if there is a fault as long as the buzzer has been activated.

Buzzer in the event of a fault

The buzzer in the event of a fault will sound 4 times at intervals with a short pause between each set of tones.

The buzzer which sounds when there is fault cannot be deactivated.

Buzzer at the end of a programme

The buzzer at the end of a programme will sound 4 times at intervals with a short pause between each set of tones.

Buzzer tones

The volume of the tone at the end of the programme can be selected in seven stages or switched off.

- Select the volume you want using the Quieter and Louder sensors, or switch the buzzer off.
- Confirm with OK.

Night time buzzer tone

You can select a different volume for the buzzer at night, or switch it off.

- Select the volume you want for the night time buzzer using the Quieter and Louder sensors, or switch the night time buzzer off.
- Confirm with OK.

Night time

You can select the times for night time to begin and end.

- Select the Start at option.
- Use the arrow sensors ∇/\wedge to set the time in hours and minutes for the night time to begin and confirm both with OK.
- Select the Finish at option.
- Use the arrow sensors ∇/\wedge to set the time in hours and minutes for the night time to end and confirm both with OK.

Keypad tone

An audible tone sounds each time a sensor is pressed.

The volume for the keypad tone can be set in seven stages, or switched off.

- Select the volume you want using the Quieter and Louder sensors, or switch the keypad tone off.
- Confirm with OK.

Memory

With the Memory function activated, the dishwasher will save the last programme that was run.

When you switch the dishwasher off and back on again, the last programme used will appear in the display instead of the ECO programme.

- Select the setting you want and confirm with OK.

Refill reminders

If you only ever use combination products containing salt and rinse aid in your dishwasher, you can switch the reminders for salt and rinse aid off if you wish (see "Settings menu, Refill reminders"). Switching off the reminders will not affect the DetergentAgent function (see "Programme options, DetergentAgent").

- Select the setting you want and confirm with OK.

If you switch to using detergent that does not contain salt or rinse aid, it is important to remember to add salt and rinse aid and to switch the reminders back on.

Check filters

You can adjust the interval at which the reminder to check the filters appears. You can set an interval of between 30 and 60 programme cycles.

The reminder to check the filters is set at the factory to appear after every 50 programme cycles.

- Select the interval you want and confirm with OK.

Automatic

You can adjust the Automatic programme so that it will remove stubborn soiling from a lightly soiled load. Energy consumption will increase with this option.

- Select the setting you want and confirm with OK.

Settings menu

AutoOpen

At the end of programmes with a drying phase the door will open automatically a little in order to help the drying process (see "Programme chart").

In the ECO programme the door will open automatically during the drying phase. In the QuickPowerWash programme it will open a few minutes after the programme has finished.

This function can be deactivated if wished.

- Select the setting you want and confirm with **OK**.



If you have deactivated the automatic door opening function and would like to open the door as soon as the programme has finished make sure that you open the door fully. Otherwise steam from the dishwasher could damage the edge of the worktop because the fan is no longer running.

Knock2open

You can choose whether the door should open with 1 or 2 knocks.

- Select the setting you want and confirm with **OK**.

This function can also be disabled in which case the door has to be fitted with a handle to open it.

Optimise standby

The dishwasher is supplied with the Optimise standby function set as standard.

To save energy the dishwasher will switch off automatically a few minutes after the last time a button has been pressed or after the end of a programme.

The dishwasher will not switch off in the event of a fault.

Optimise standby can be switched off if you prefer. If you do this the duration before the dishwasher switches off increases to 6 hours. Doing this will increase energy consumption.

- Select the setting you want and confirm with **OK**.

BrilliantLight

This dishwasher has interior lighting. When the door is open the lighting will switch off automatically after 15 minutes.

You can also switch off the interior lighting permanently.

- Select the setting you want and confirm with **OK**.

Heat exchanger

This dishwasher is equipped with a heat exchanger (see "Programme options, Heat exchanger").

Conditions

The heat exchanger function can be switched off if you do not wish to use it.

- Select the **State** option.
- Select the setting you want and confirm with **OK**.

Manual discharge

You can manually empty the heat exchanger, e.g. for a longer period of down time, or before moving the appliance to a new location.

- Select the **Empty manually** option and confirm with **OK**.

The process starts straight away.

Settings menu

Software version

You can call up the electronic software version of your dishwasher for technical support purposes.

- Confirm the display with **OK**.

Showroom programme

For demonstration purposes only.

The dishwasher is equipped with various demo programmes for showroom use.

- Demo mode
Programme for use in showrooms to demonstrate the TimeControl function.
- Demo with sound
This programme activates the circulation pump to demonstrate the sound of the dishwasher.
- Demo AutoOpen
The door will open automatically.
- Cont. BrilliantLight
The interior lighting is on constantly.

Factory default



You can reset all dishwasher settings to the factory default settings.

You will be given the choice of Appliance settings or Main menu.

WLAN module settings (where applicable) have to be reset separately (see "Settings, Miele@home, module settings").

- Select the one you want to reset.
- Confirm the message Reset settings? or Reset main menu? with **Yes**.

To close the Settings menu

To close the Settings  menu use the  sensor. This will take you back to the main menu.

United Kingdom

Miele Co. Ltd.
Fairacres, Marcham Road
Abingdon, Oxon, OX14 1TW
Customer Contact Centre Tel: 0330 160 6600
E-mail: mielecare@miele.co.uk
Internet: www.miele.co.uk

Australia

Miele Australia Pty. Ltd.
ACN 005 635 398
ABN 96 005 635 398
1 Gilbert Park Drive, Knoxfield, VIC 3180
Tel: 1300 464 353
Internet: www.miele.com.au

China

Miele (Shanghai) Trading Ltd.
1-3 Floor, No. 82 Shi Men Yi Road
Jing' an District
200040 Shanghai, PRC
Tel: +86 21 6157 3500, Fax: +86 21 6157 3511
E-mail: info@miele.cn, Internet: www.miele.cn

Miele (Hong Kong) Limited

41/F - 4101, Manhattan Place
23 Wang Tai Road
Kowloon Bay, Hong Kong
Tel: (852) 2610 1025, Fax: (852) 3579 1404
Email: customerservices@miele.com.hk
Website: www.miele.hk

India

Miele India Pvt. Ltd.
Ground Floor, Copia Corporate Suites
Plot No. 9, Jasola, New Delhi - 110025
Tel: 011-46 900 000, Fax: 011-46 900 001
E-mail: customercare@miele.in, Internet: www.miele.in

Ireland

Miele Ireland Ltd.
2024 Bianconi Avenue
Citywest Business Campus, Dublin 24
Tel: (01) 461 07 10, Fax: (01) 461 07 97
E-Mail: info@miele.ie, Internet: www.miele.ie

Manufacturer: Miele & Cie. KG

Carl-Miele-Straße 29, 33332 Gütersloh, Germany

Miele

Malaysia

Miele Sdn Bhd
Suite 12-2, Level 12
Menara Sapura Kencana Petroleum
Solaris Dutamas No. 1, Jalan Dutamas 1
50480 Kuala Lumpur, Malaysia
Phone: +603-6209-0288
Fax: +603-6205-3768

New Zealand

Miele New Zealand Limited
IRD 98 463 631
Level 2, 10 College Hill
Freemans Bay, Auckland 1011, NZ
Tel: 0800 464 353
Internet: www.miele.co.nz

Singapore

Miele Pte. Ltd.
163 Penang Road
04 - 03 Winsland House II
Singapore 238463
Tel: +65 6735 1191, Fax: +65 6735 1161
E-Mail: info@miele.com.sg
Internet: www.miele.sg

South Africa

Miele (Pty) Ltd
63 Peter Place, Bryanston 2194
P.O. Box 69434, Bryanston 2021
Tel: (011) 875 9000, Fax: (011) 875 9035
E-mail: info@miele.co.za
Internet: www.miele.co.za

United Arab Emirates

Miele Appliances Ltd.
Gold & Diamond Park
Office No. 217-6, Sheikh Zayed Road
P.O. Box 11 47 82 - Dubai
Tel. +971 4 3044 999
Fax. +971 4 3418 852
800-MIELE (64353)
E-Mail: info@miele.ae
Website: www.miele.ae

G 6992 / G 6997



en-GB

M.-Nr. 10 384 700 / 05